

Installing The Levers

Inside Lever

- See previous page

Conventional Cylinder (Figure A)

Outside Lever

- Tailpiece must be in a vertical position in cylinder. (Fig. A1)
- Insert cylinder in lever.
- Press cylinder retainer into lever until flush with base of lever.
- Align lever catch to face latch front (see Fig. 6).
- Turn key in cylinder 45° in either direction.
- Slide lever on tube until it stops at the lever catch.
- Slightly wiggle and push until lever engages lever catch and connector.

Conventional Tailpieces For the Door Gard LS-1	
Part No.	For
LS1P-TLS	IEI Cylinders
LS1P-TIL	Ilco Cylinders
LS1P-TSG	Schlage Cylinders

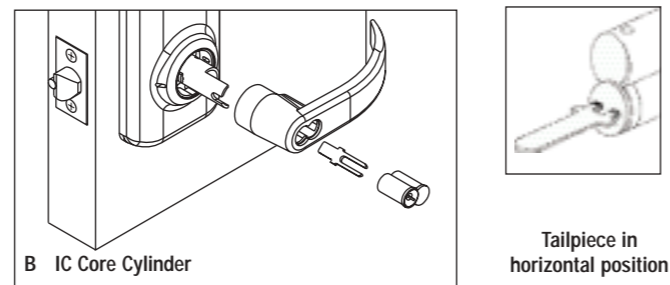

IC Core Cylinder (Figure B)

Installing IC Core

- Push lever on door in **horizontal** position until secure.
- Insert control key (marked with a "C") into IC core and turn **clockwise**.
- Insert **tailpiece** (See chart below.) into core. (Fig. B1)
- With control key in **core**, insert core fully into lock.
- Turn **control key 15°** to lock cylinder in place. Remove control key.

I.C. Tailpieces For the Door Gard LS-1		
	Part No.	For
ER	LS1P-TIC7	7 pin IC Core Cylinder
TICS	LS1P-TICS	Spacer to convert 7 pin tailpiece for use with 6 pin ic core.

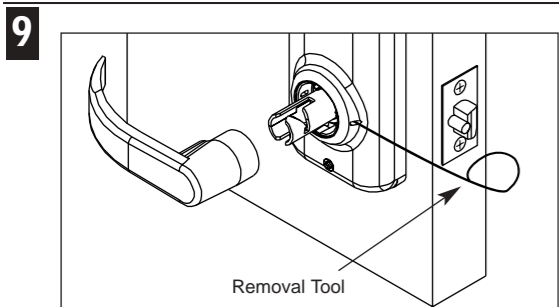
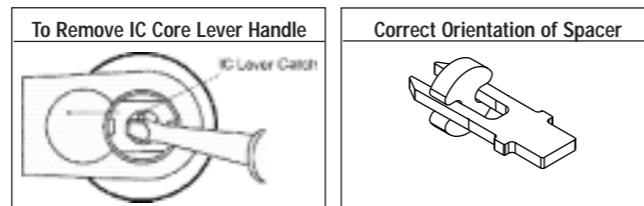

Removal of Levers

Inside Lever

- Insert lever **removal tool** in slot. (Fig. 9)
- Depress lever **catch** and pull lever to remove.

Outside Lever

- Insert key into cylinder and turn 45° in either direction.
- Insert lever **removal tool** in slot. (Fig. 9A)
- Depress lever catch and pull lever to remove.

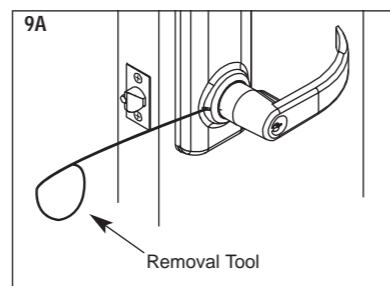

Warranty — International Electronics Incorporated (IEI) warrants its products to be free from defects in material and workmanship, when they have been installed in accordance with the manufacturers instructions, and have not been modified or tampered with. IEI does not assume any responsibility for damage or injury to person or property due to improper care, storage handling, abuse, misuse, normal wear and tear, or an act of God. IEI's sole responsibility is limited to the repair (at IEI's option) or the replacement of the defective product or part when sent to IEI's facility (freight and insurance charges prepaid), after obtaining IEI's Return Merchandise Authorization. IEI will not be liable to the purchaser or any one else for incidental or consequential damages arising from any defect in, or malfunction of, its products. This warranty shall expire two years after shipping date for Prox. Pad Keypads. Except as stated above, IEI makes no warranties, either expressed or implied, as to any matter whatsoever, including, without limitation to, the condition of its products, their merchantability, or fitness for any particular application.

DOOR GARD™ LS-1

ACCESS CONTROL LOCKSET

Installation Instructions



©2001 INTERNATIONAL ELECTRONICS, INC.
427 TURNPIKE STREET, CANTON, MA 02021
(781) 821-0734 • www.ieib.com
FAX INFO CENTER: (781) 821-0734
REFER TO DOC. #6058003 FOR CUT-SHEET
REFER TO DOC. #6058004 FOR PROGRAMMING MANUAL
REFER TO DOC. #6058005 FOR INSTALLATION INSTRUCTIONS
REFER TO DOC. #6108004 FOR INSTALLATION TEMPLATE

1

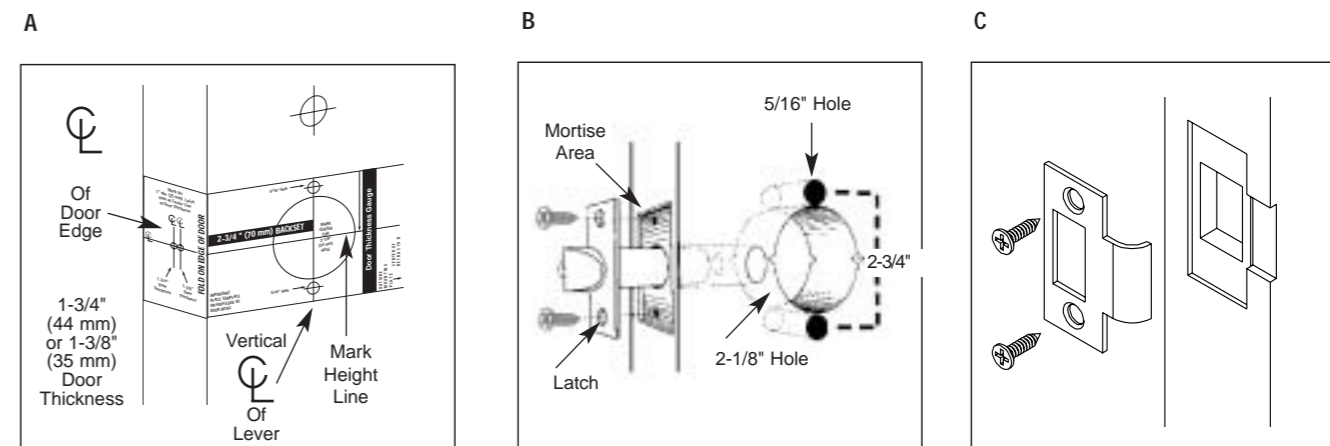

- A. Affix paper template to door and follow template instructions in preparing door.

- B. Install latch.

- C. Install strike.

Note: See template for measurements.

2

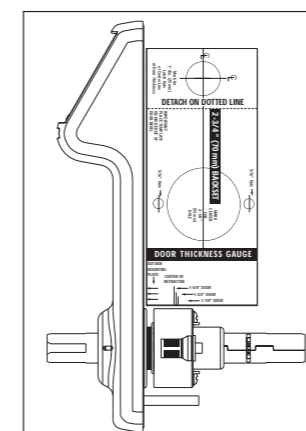

- Locks are factory assembled with a split spacer ring for 1-3/4" door thickness, (when lock chassis is firmly against ring.)
- Locks can be adjusted for 1-5/8" to 1-7/8" door thickness. Before installation, use **door thickness gauge on template** (as shown), to check lock chassis position. Center of latch retractor should align with mark on gauge for appropriate door thickness.
- If chassis is not on center, screw chassis in or out to align with mark. If adjusting for doors thinner than 1-3/4" thickness, split spacer must be removed. **Check that lever engages lever catch before installation.**
- Make sure to adjust for correct door thickness.

2A

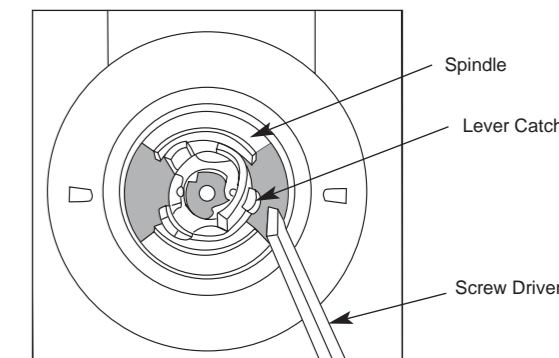

- To adjust lockset for desired door thickness, turn lock chassis in the direction to adjust for narrow or thick doors. (For narrow doors, remove split spacer ring.) It may be necessary to depress the lever catch on spindle in order to rotate the chassis and spindle.
- Using a standard screwdriver depress lever catch to clear spindle support collar while turning lock chassis. Turn spindle to adjust for correct door thickness.
- Once lock is adjusted for door thickness, install exterior lever and check that lever engages lever catch before completing lock installation. Lever should snap securely into place with no play. If lever wobbles or does not engage with catch, turn spindle until lever snaps into place.
- Complete lockset installation.

Installation Instructions

3

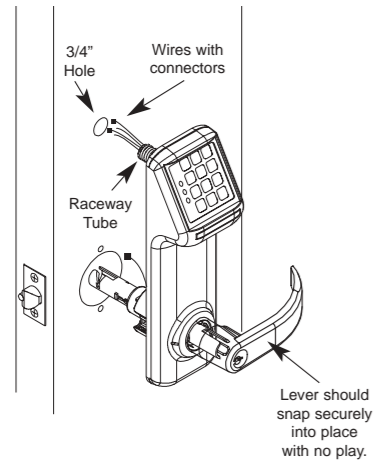

Pass the wires and connectors through the 3/4" hole, then mount the exterior housing through door preparation. Make sure that the lock chassis and latch are properly engaged as shown. (See Fig. 2A)

4

1. Remove screw from Battery Cover to access backplate.
2. Feed the wires and connectors through the backplate and raceway nut. Install lock washer on the raceway nut.
3. While holding the interior backplate in position, loosely install the two thru-bolts.
4. Tighten the raceway nut on the raceway tube that passes through the door using a crescent or 7/8" socket wrench. When this connection is tight, secure the thru-bolts.
5. Install two screws to the backplate to the door (wooden door application). The two predrilled holes on the backplate are located below the raceway nut.

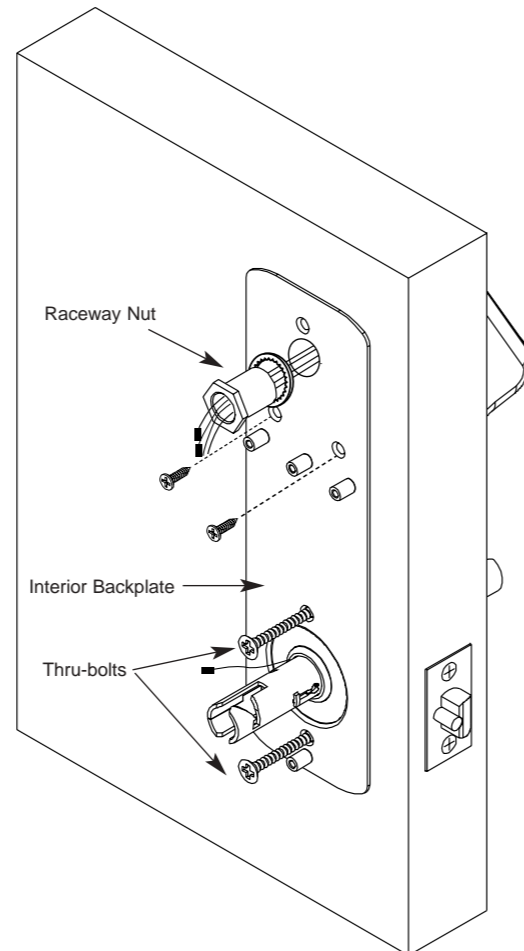
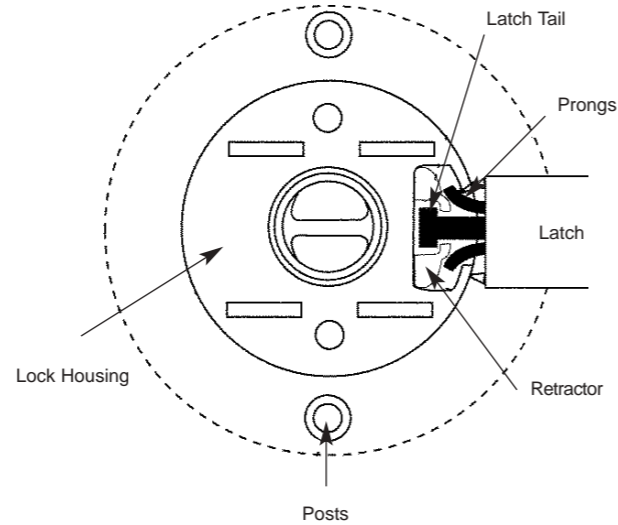

Figure 2A



5

Note: It is recommended to use only alkaline batteries, due to predetermined power settings in the lock.

Insert 4 AA batteries into battery holder. (Note polarity.)

Note: All wire pairs are color coded to connect with like colored pairs.

1. Connect the grey/red wires from the raceway to the grey/red wires from the lever tube.
2. Connect the red/black wires from the raceway to the red/black wires from the battery pack. The four remaining wires are only for the optional door position switch, as well as the request to exit (REX) function. (See the programming manual for details.)
3. Place the battery holder over the center grooved stud. Note: The fork, located on the bottom of the battery holder will clear the lower inside housing.
4. When properly aligned, push down on the battery holder assembly, engaging the upper part of the hole into the groove of the center stud. This will connect the lower fork with the center post, giving a very secure fit.

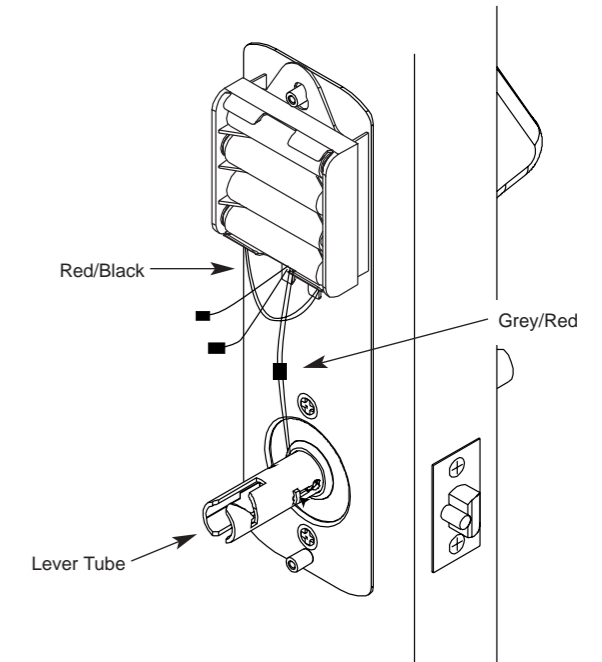

6

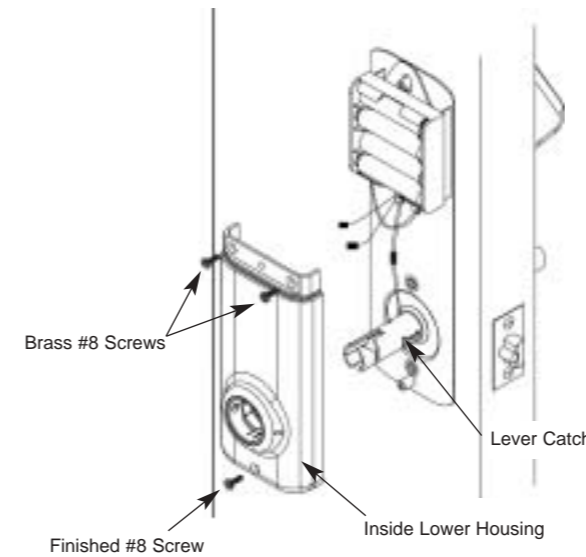

1. Slide the inside lower housing over the lever tube until it has passed over the lever catch. Make sure the four remaining wires (if not used) are properly placed so they are not pinched by the lower housing.
2. Fasten with two brass #8 screws. Once secure, fasten the finished #8 screw at the bottom.

7

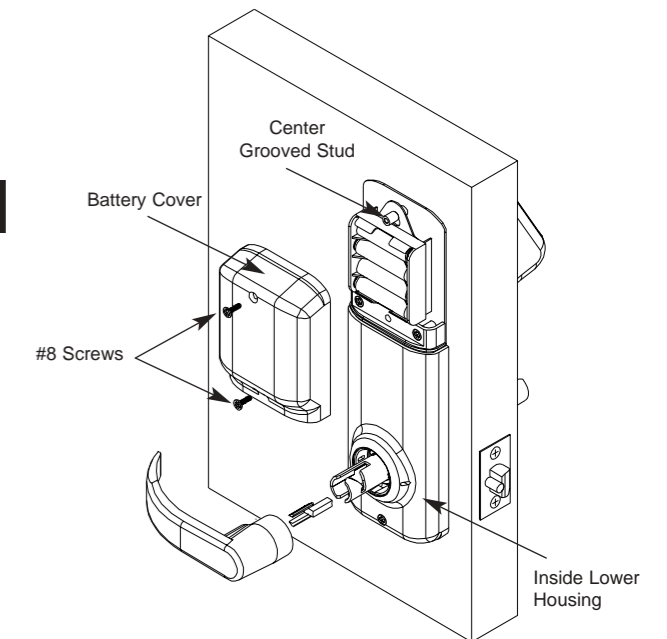

PUSH ALL EXCESS WIRE LENGTHS DOWN THROUGH THE OPENING AT THE TOP OF THE INSIDE LOWER HOUSING.

1. Attach the battery cover with two finished #8 screws. Battery cover has a lip which engages the lower inside housing, it is important that this lip be seated properly to insure correct alignment.
2. Insert cylinder retainer into lever until flush with base of lever.
3. Push level on door in horizontal position until secure.