



23792492

R/V Trim  
R/V Moldura  
R/V Garniture

Installation Instructions  
Instrucciones de instalación  
Notice d'installation

**1** Transfer  $\mathcal{C}$  from device side to trim side of door  
Transfiera  $\mathcal{C}$  desde el lado del mecanismo al lado de la moldura de la puerta  
Transfert  $\mathcal{C}$  du côté du dispositif vers la garniture latérale de porte

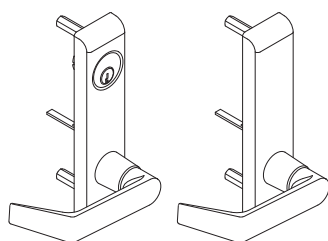
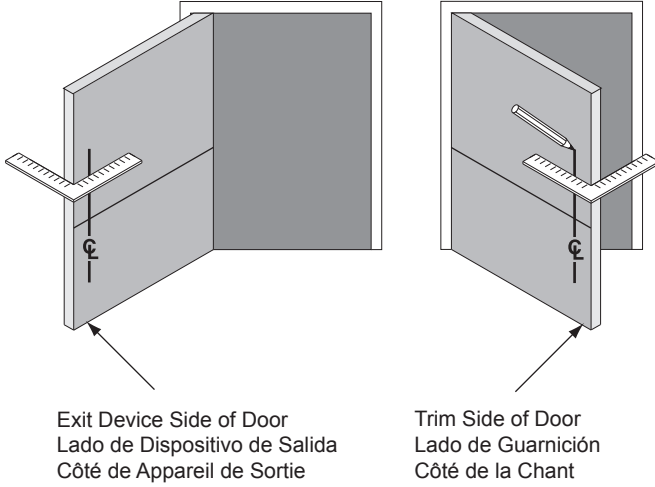

712L  
712L-NL      712L-BE

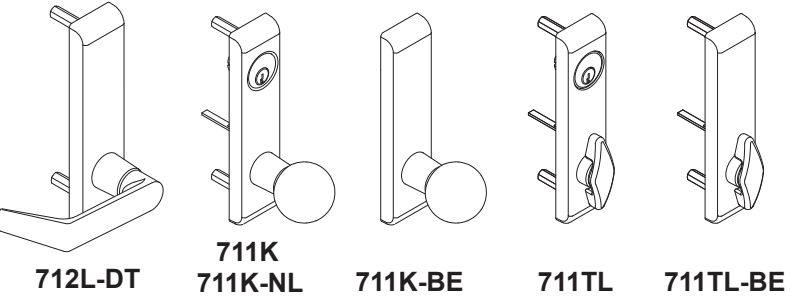
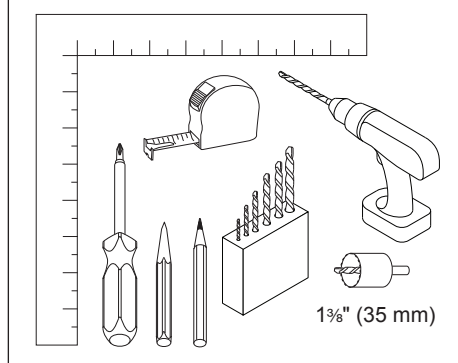

712L-DT      711K  
711K-NL      711K-BE      711TL      711TL-BE

**2** Prepare Door  
Prepare la Puerta  
Préparer la Porte

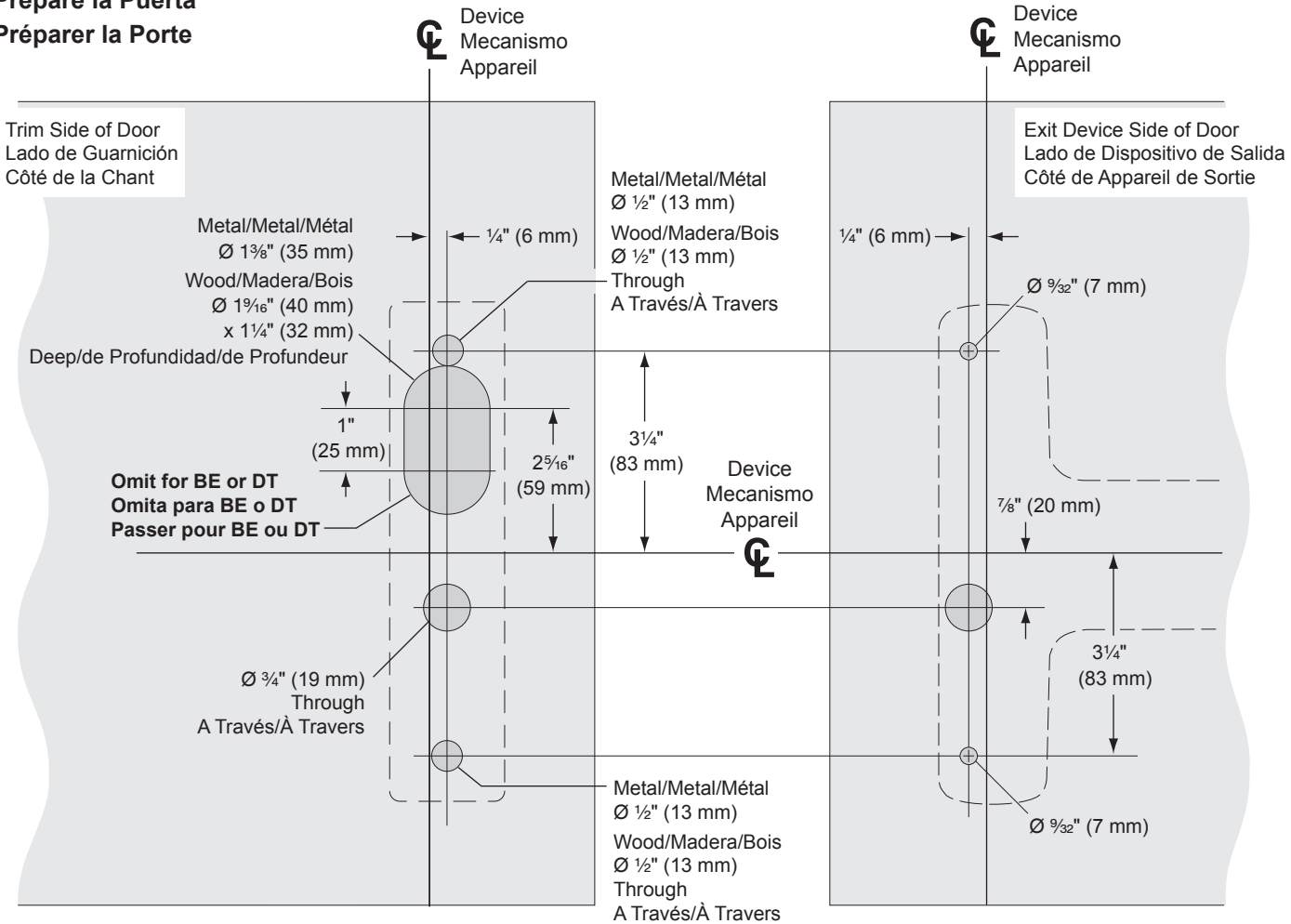

**3** Assemble Tailpiece  
Arme la cola del pestillo  
Assembler la pièce de raccordement

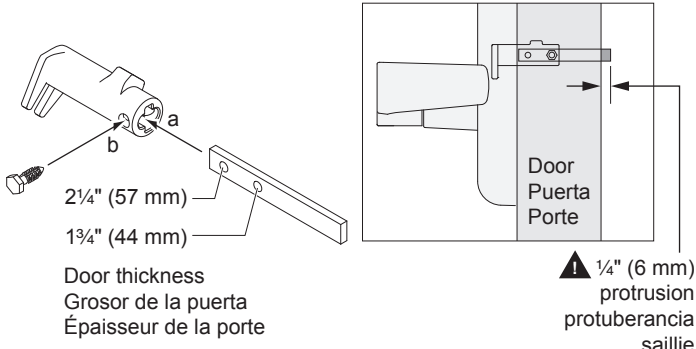

**4** Install Tailpiece Guide into Exit Device Cam  
Instale la guía de la cola del pestillo en la cámara del dispositivo de salida  
Installer le guide de la pièce de raccordement dans la caméra de l'appareil de sortie

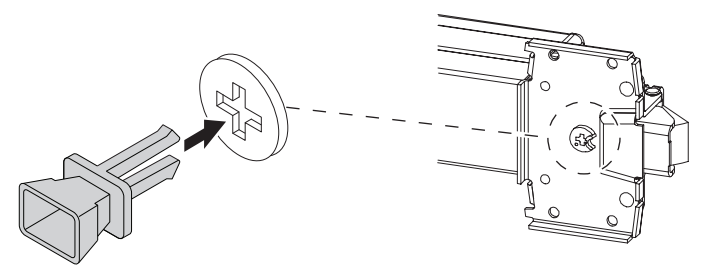

**5**

**If Necessary, Rehand Trim**

**De ser necesario, ajuste la moldura**

**Réutiliser la garniture si nécessaire**

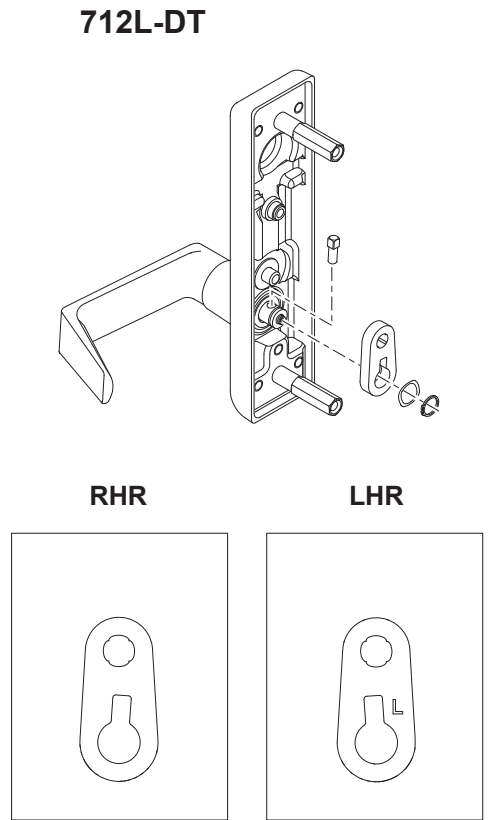
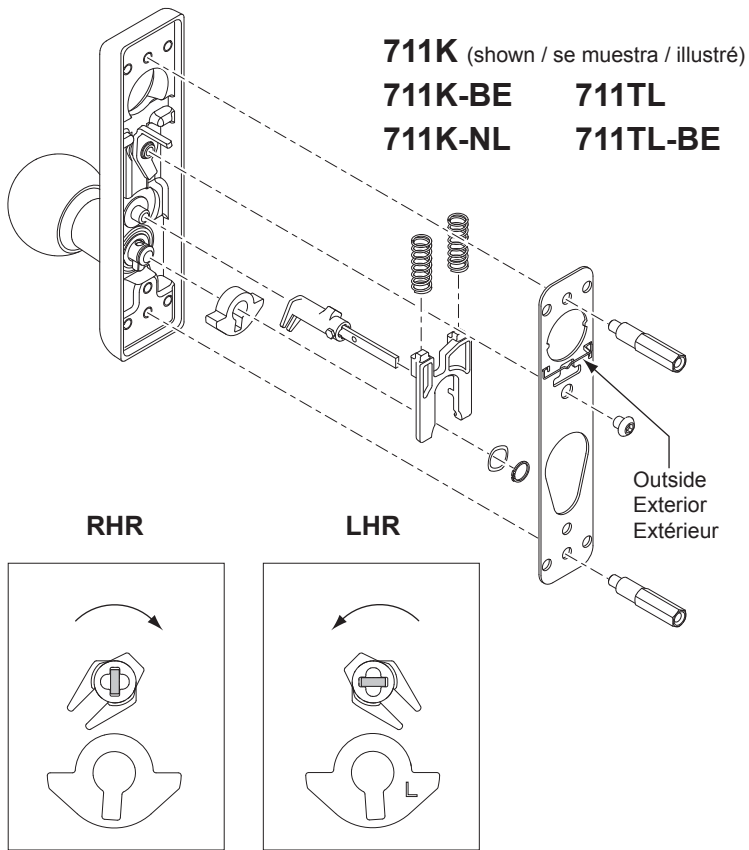
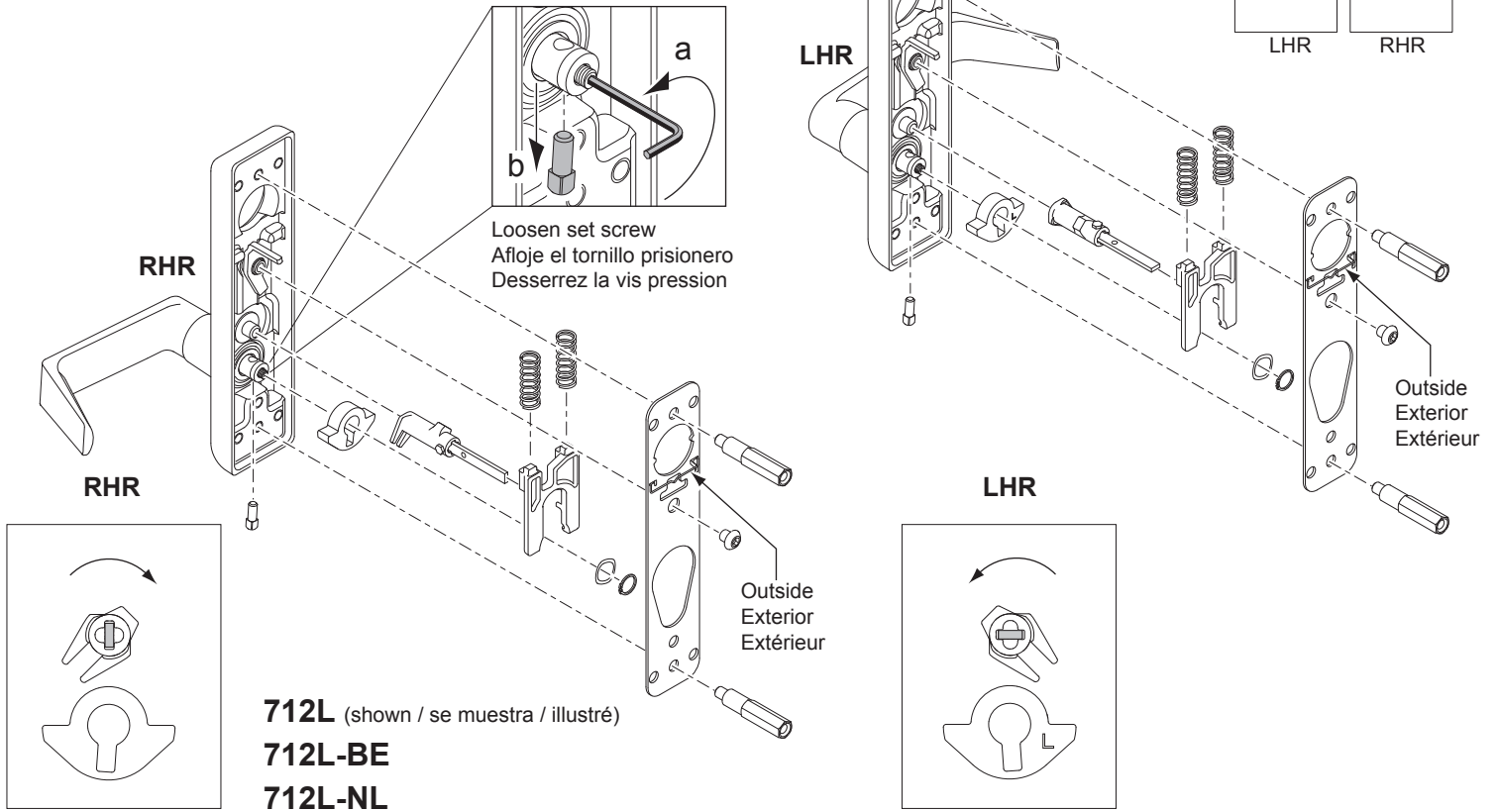

**6**

**If Necessary, Install Cylinder**

**De ser necesario, instale el cilindro**

**Installer le cylindre si nécessaire**

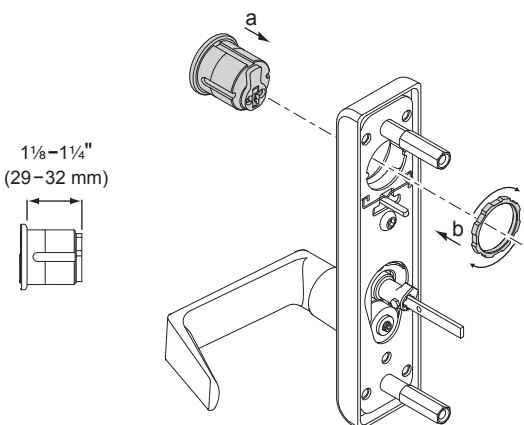

**7**

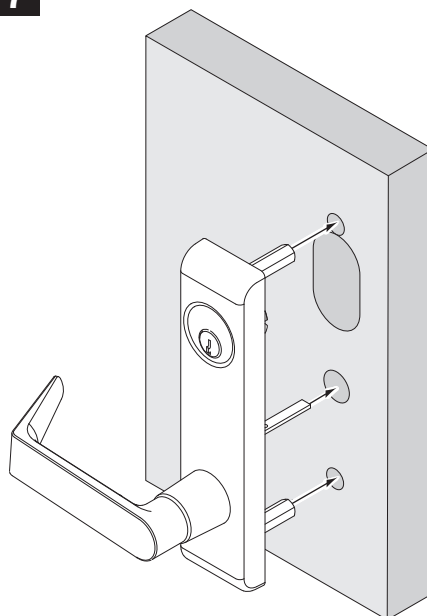

**Return to  
Device Instructions  
Regrese a Instrucciones  
del mecanismo  
Retour vers les  
instructions du dispositif**

**Customer Service  
Servicio al cliente  
Service à la clientèle**  
1-877-671-7011 [www.allegion.com/us](http://www.allegion.com/us)

