



829695-00

Push/Pull Mortise Latch

Installation Instructions

NOTE

When cylinder application is used, paddle on key side may be mounted in down position or horizontal.

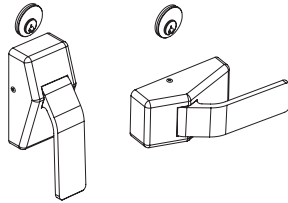

OR

When thumbturn application is used, paddles must be mounted in horizontal position only.

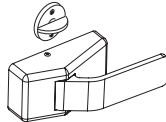

1 Use Templates #1 and #2 to Check Holes

NOTE: If door holes do not match template, see Door Preparation section.

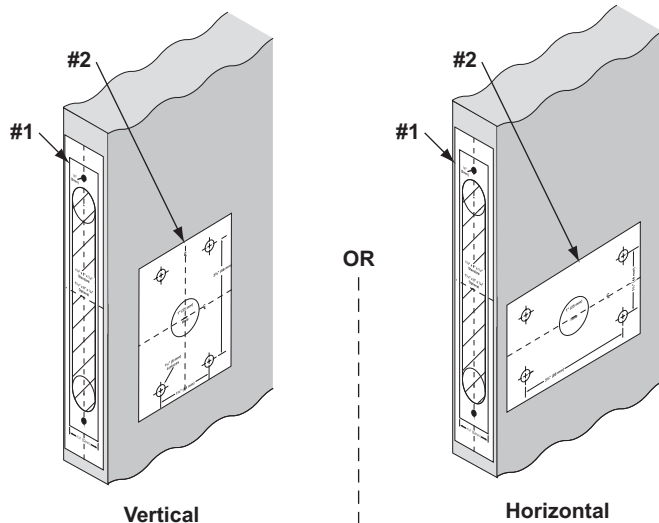

2 Install Studs

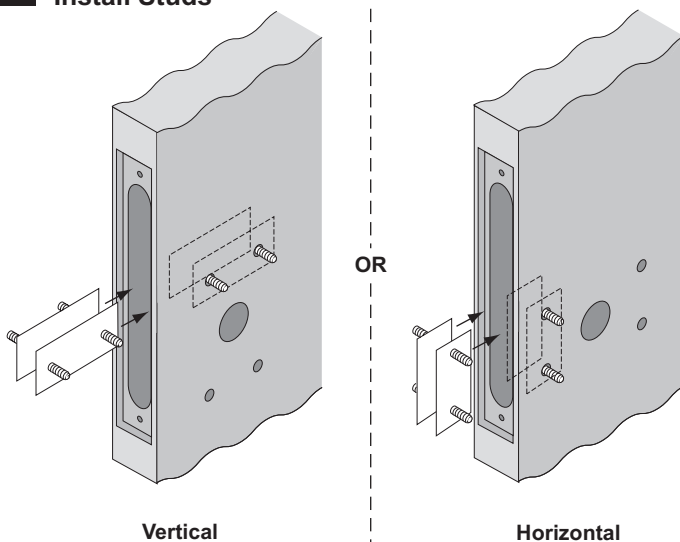

3 For HL6ML (Lead Lined) ONLY, Install Lead Plate

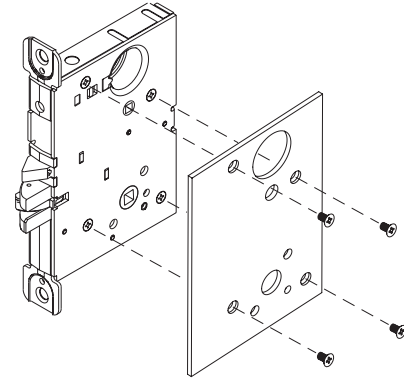

4 Install Mortise Lock

NOTE: To reverse latch, pull out and rotate 180 degrees.

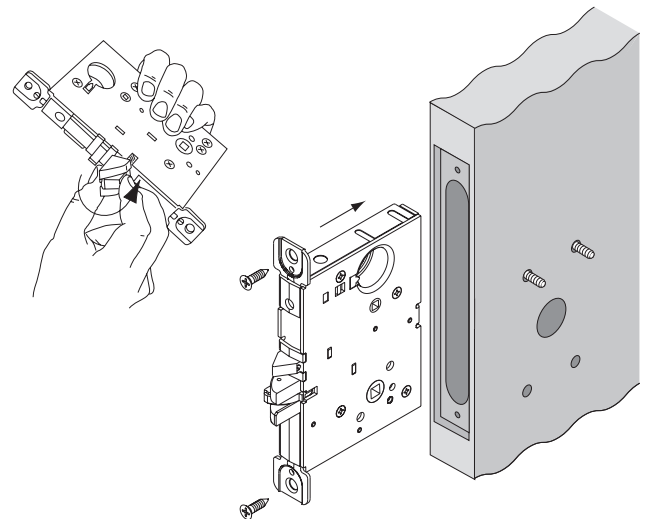

5 Install Cylinder or Thumbturn, as Required

NOTE: Uses 1-1/8" mortise cylinder with a cover leaf.

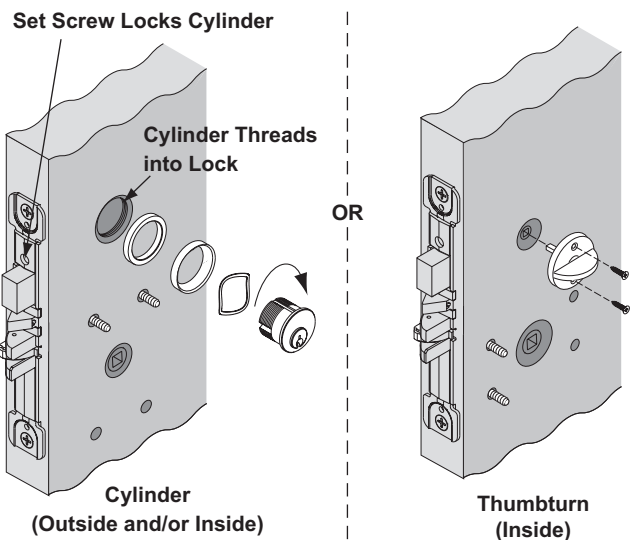

6 Position Cams as Shown

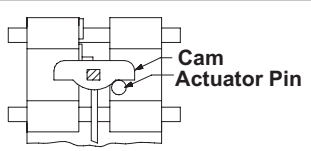
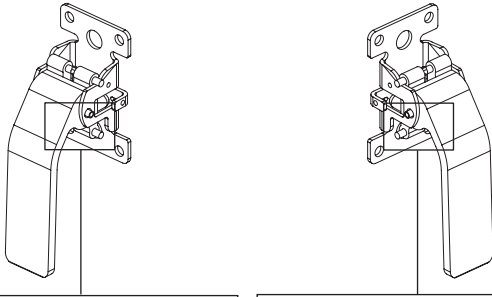

Push handle

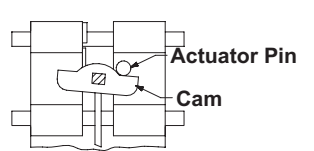

Pull handle

7 Install Push and Pull Levers

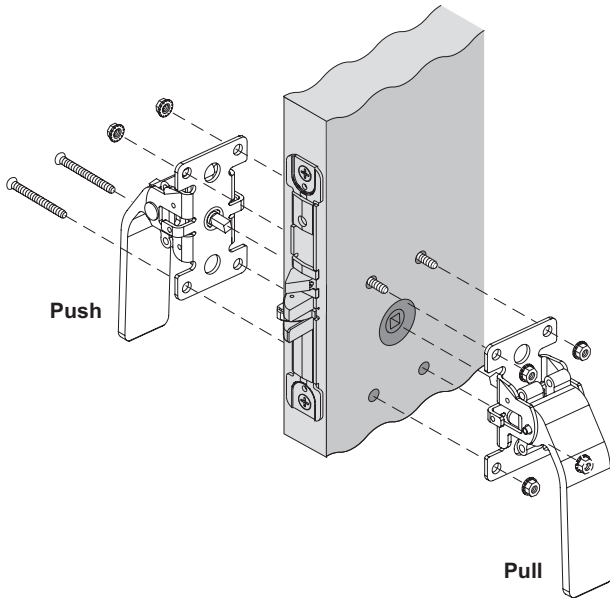

Push

Pull

8 Install Covers and Armor Plate

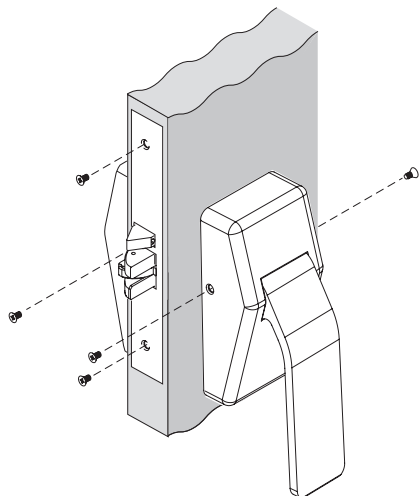

9 Install Strike

NOTE: If frame not prepared, see Frame Preparation below.

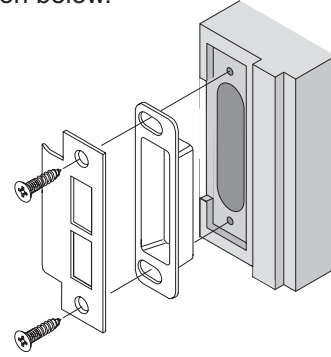

Frame Preparation

1 Locate Strike Center Lines (☉) on Frame

NOTE: Horizontal strike ☉ is located $\frac{3}{8}$ " (10 mm) above Lock ☉.

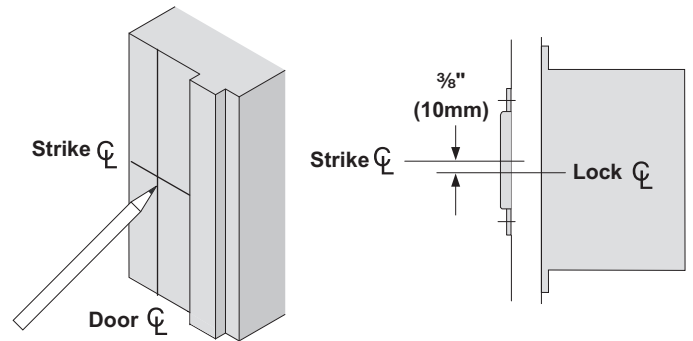

Strike ☉

Door ☉

Strike ☉

$\frac{3}{8}$ "
(10mm)

Lock ☉

2 Mark Frame Using Template #3

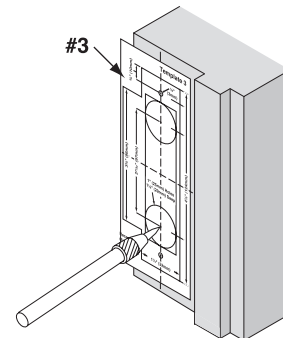

#3

3 Drill and Mortise Frame per Template

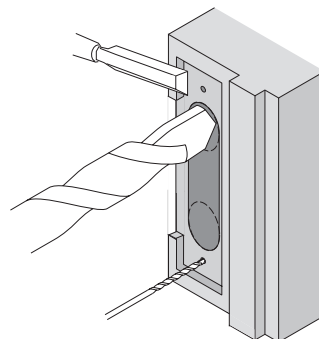

Door Preparation

1 Mark Center Lines (☉)

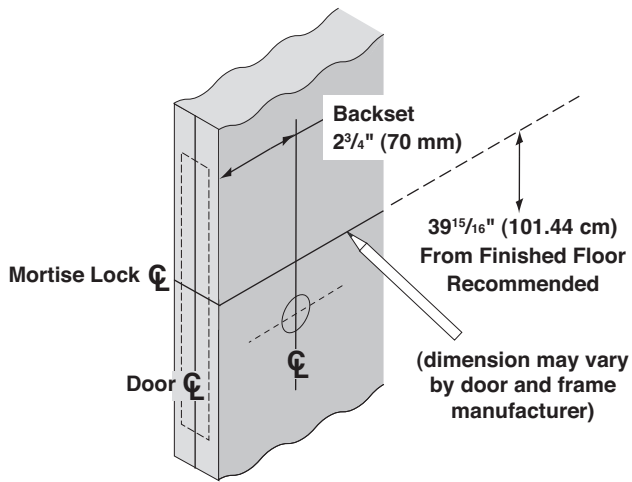

2 Mark Door using Template #1 and #2

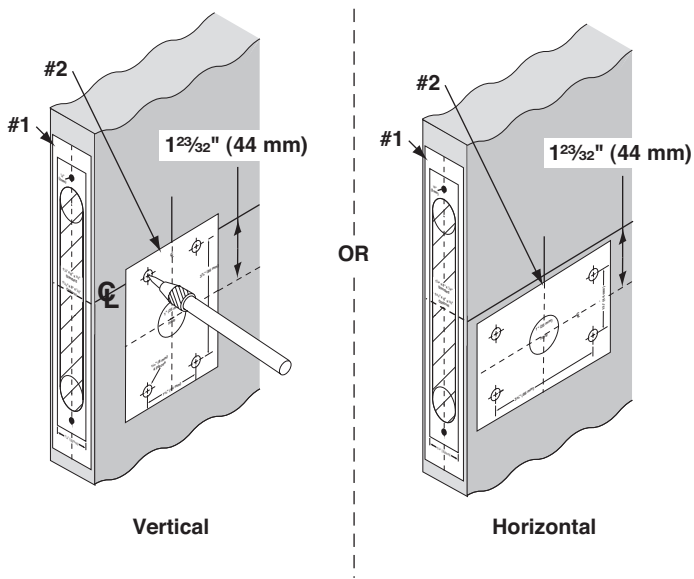

3 Drill and Mortise Door per Template

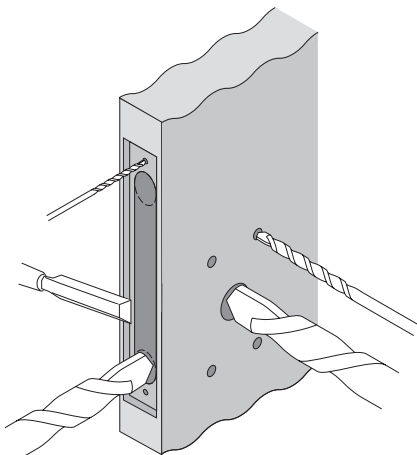

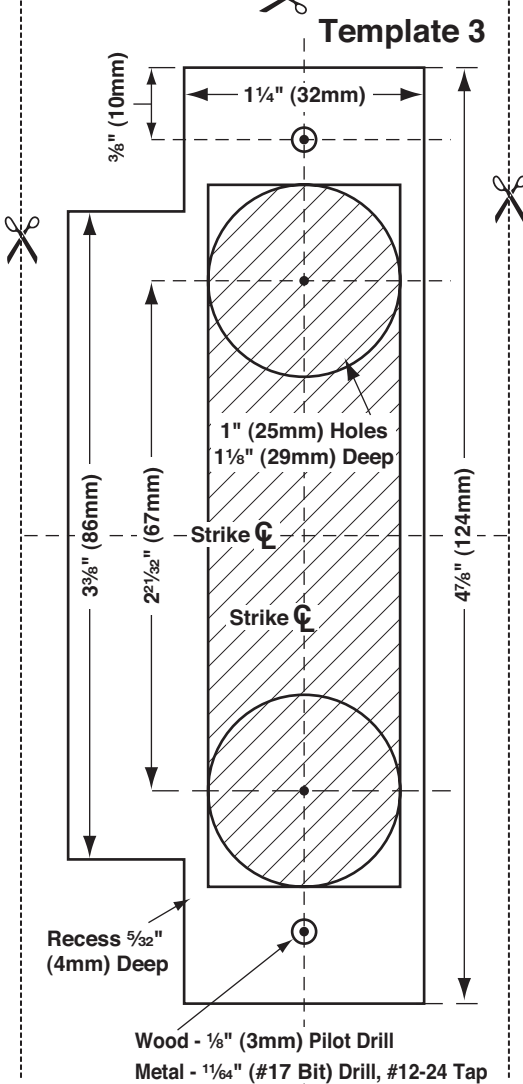
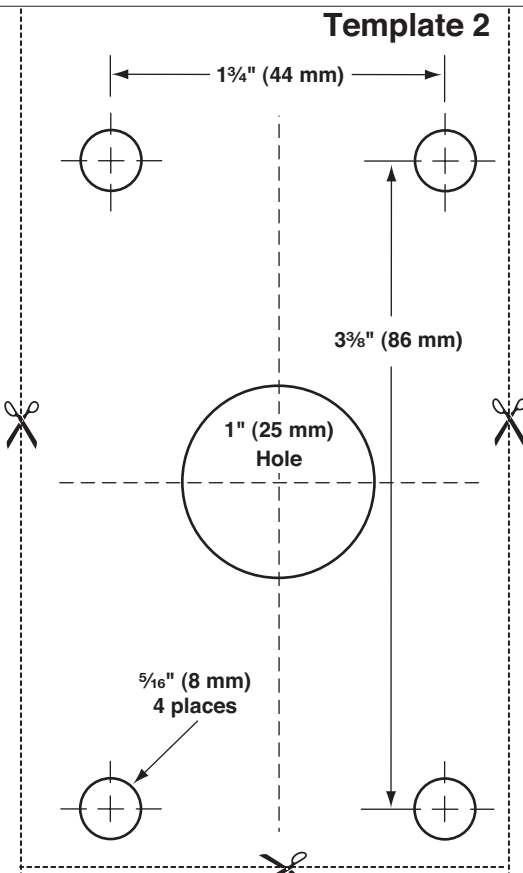
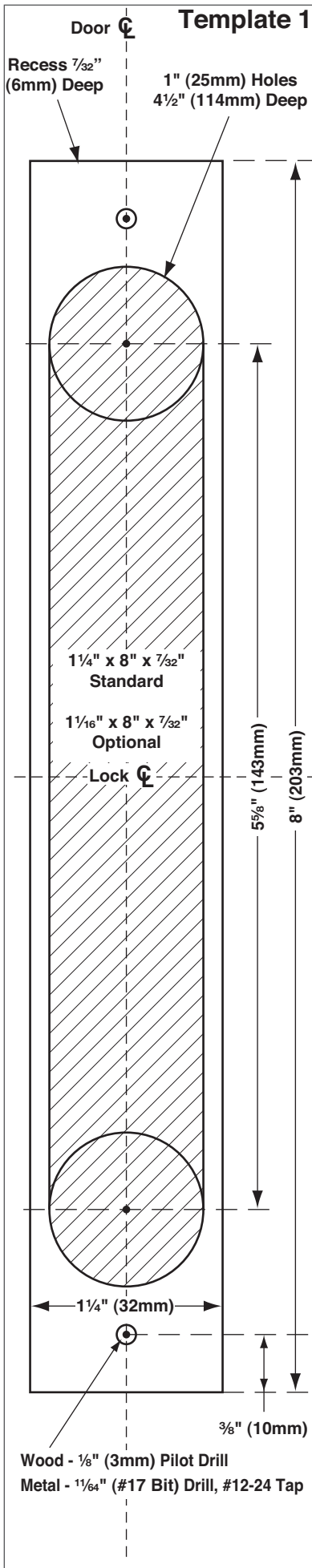

Preparation for Cylinder

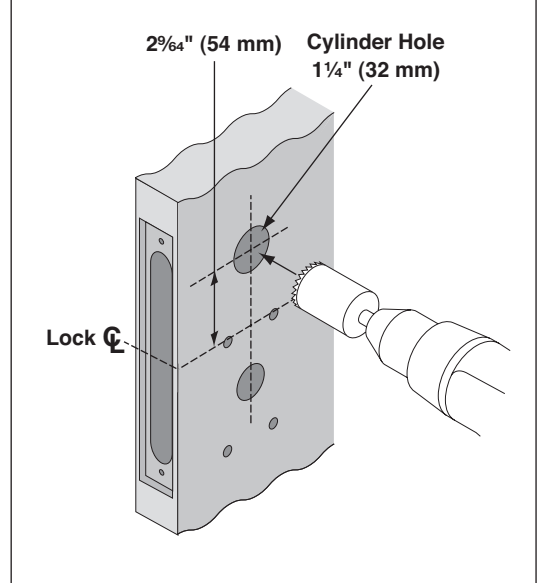

Preparation for Thumbturn

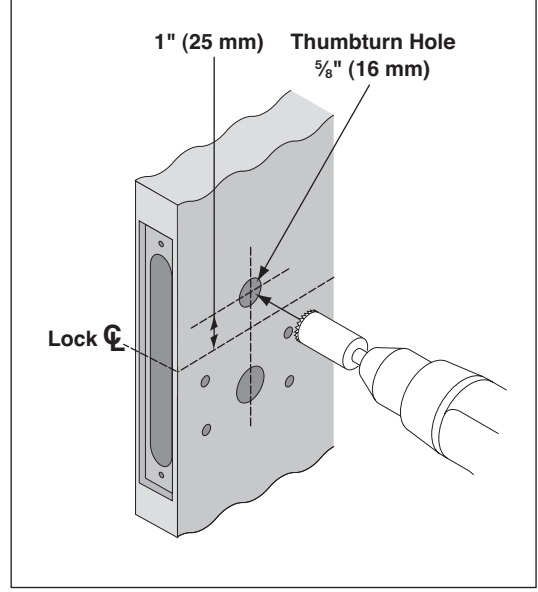

Customer Service
1-877-671-7011 www.allegion.com/us

