

9530 SERIES

FEATURES

SINGLE DOOR, SURFACE MOUNT (PULL) OFFSET PIVOT/BUTT HINGE

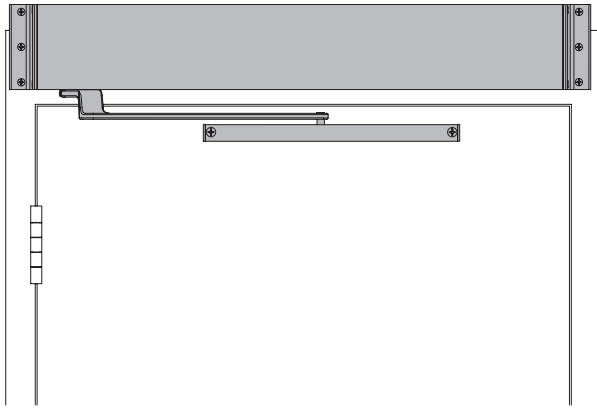

The 9530 SENIOR SWING by LCN is an ADA door operator that is a two-in-one swing door operator. SENIOR SWING operators when activated, opens doors automatically for wheelchair access, yet allows for manual operation for regular pedestrian traffic.

- Push 'N Go permits non-switch activation.
- Power Boost provides additional latching force.
- Electromechanical unit with microprocessor control.
- Digital keypad for easy setup.
- Meets International Building Code requirements and ANSI A156.19.
- UL approved for fire doors.

- 9530 Series operator is shipped with motor gearbox, control box, standard arm, header, and mounting hardware. Actuators available separately, see pages 122-137.
- Single door, surface mounted.
- Meets ADA requirements (power mode only).
- Handed product.
- 36" header length is standard. Specify length 33" to 48" max.
- Double door header available up to 98", specify other length 49" to 98" max. Consult factory regarding this option.
- Adjustable hold open period of 2 to 32 seconds in automatic or manual mode.

9530 Series is fully compliant with UL 325 & UL 1998 and meets the provisions of ANSI A156.19. The 9530 Series is UL listed for fire-rated applications. The 9530 Series also meets the provisions of the Americans with Disabilities Act.

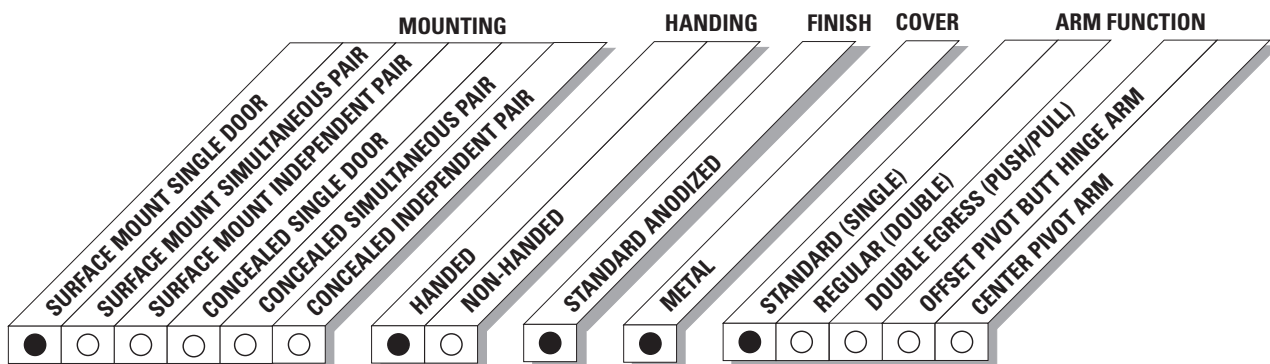

● AVAILABLE
○ NOT AVAILABLE

9530 SERIES

TOP JAMB SINGLE DOOR (OFFSET PIVOT/BUTT HINGE, CENTER PIVOT, PULL) MOUNTING

NOTE: Cannot be used with swing clear hinges, pocket pivots or balanced doors.

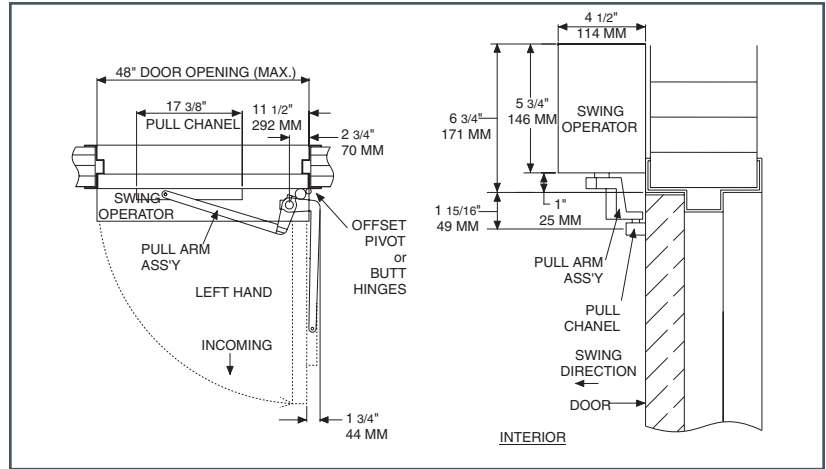

HOLLOW METAL FRAME

Suggested Installation.

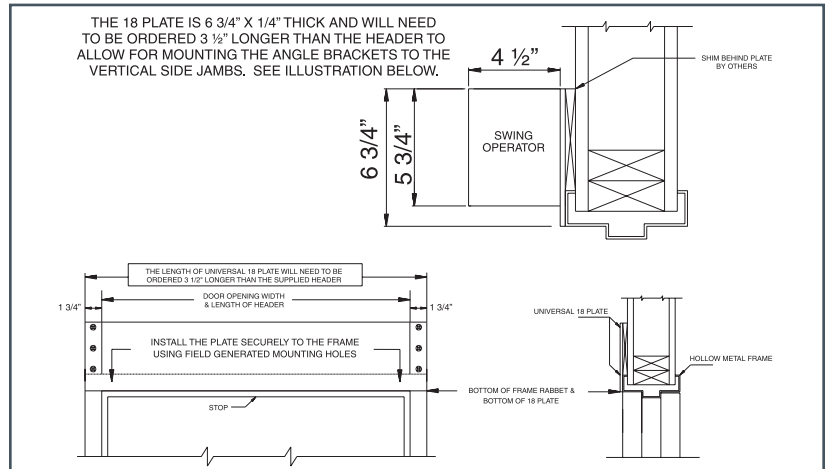

MAXIMUM OPENING

Template allows 90 degree power opening and 90 degree manual opening.

- **Butt Hinges** should not exceed 5" (127 mm) in width.
- **Reveal** should not exceed 4" (102 mm).
- **Head Frame** minimum 1-3/4" (44 mm). Face frame 6-3/4" (171 mm) total operator clearance.
- **Top Rail** minimum 2-3/4" (70 mm).
- **Opening & Closing Time** are variable by adjustments to the electronic control box. Maximum hold open time adjustable up to approximately 32 seconds.
- **System Diagram** see "AUTOMATIC OPERATORS" section pages 53 for typical system wiring and page 56 for electrical data.

Contact LCN Product Support for installation assistance.

9530 SERIES

MOTOR GEARBOX

MOTOR GEARBOX – SENIOR SWING, 9530-3454

Driving mechanism for operator. Provides maximum of 15 lbs opening force. Handed.

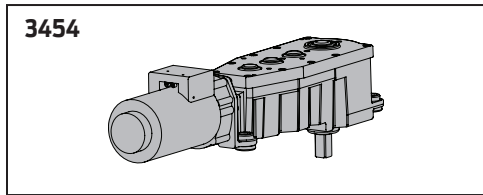

MOUNTING BRACKET

MOUNTING BRACKET – 2-3/4", 9530-275

Motor gearbox mounting bracket for 2-3/4" offset pivot or butt hinge installations. Front bracket.

REAR MOUNT BRACKET, 9530-3018

Motor gearbox mounting bracket. Rear bracket.

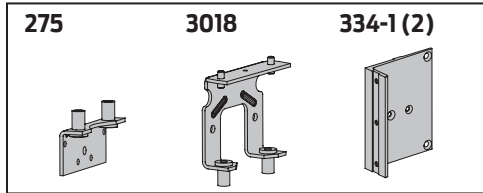

ANGLED BRACKET, 9530-334-1

Mounting bracket for surface applications. (Includes 2 mounting brackets).

CONTROL BOXES

CONTROL BOX – SENIOR SWING, 9530-3462

Electronic controlling device for Senior Swing.

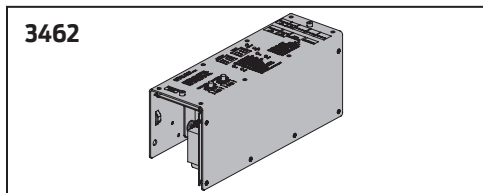

HEADERS

HEADER, 9530-3572HL

Standard, mounting header. Single door, single operator. Specify length 33" to 48" maximum.

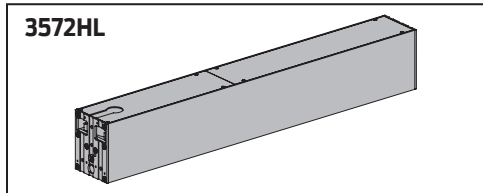

HEADER, 9530-3572DD

Standard, mounting header. Double door, single operator. Specify length 49" to 98" maximum.

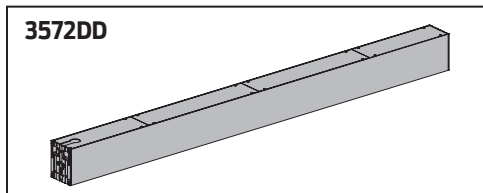

END CAPS

HEADER END CAPS, 9530-334

End cap with openings for wiring.

END DRESS PLATE, 9530-334-2

Metal finish end cap.

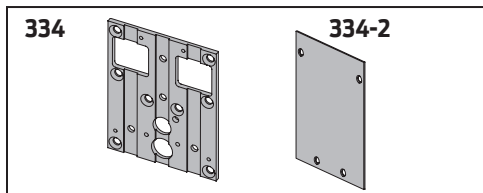

9530 SERIES

ARMS

STANDARD ARM ASSEMBLY, 9530-3077PLCM

Handed arm. Track roller included. (Includes 3038, 3077T, 3034 & 73).

STANDARD ARM, 9530-3077T

Handed arm. Track roller not included.

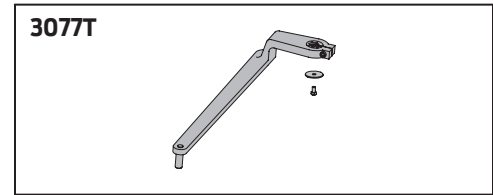
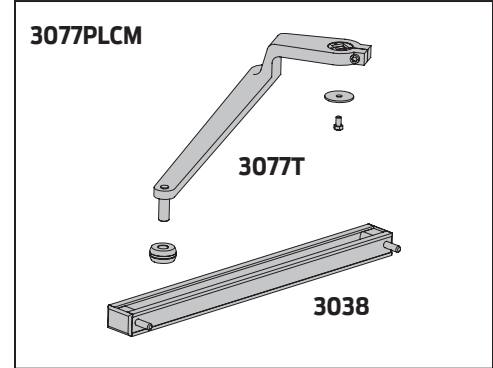

TRACKS

TRACK 9530-3038

Standard non-handed track. (Includes 3034 & 73).

TRACK END CAP 9530-73

Black plastic end caps.

ROLLER, 9530-3034

Quiet low friction roller assembly.

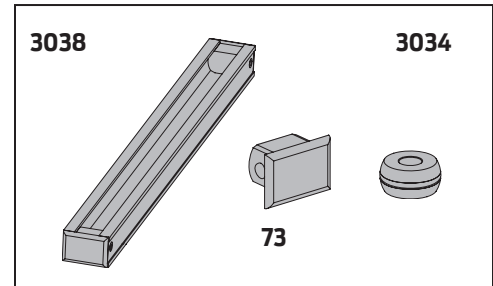

INSTALLATION ACCESSORIES

SPINDLE PLATE – 2-3/4", 9530-11A

Hides bottom of motor gearbox. Completes header box. Cutout allows for motor gearbox shaft. For 2-3/4" offset pivot or butt hinge installations.

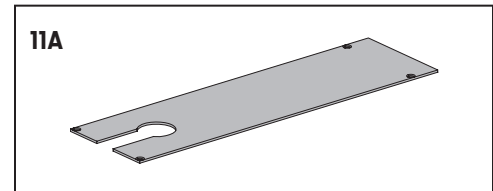

FILLER PLATE BLANK, 9530-12

Completes length of header box. (Specify Length).

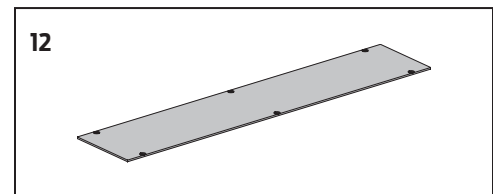

MOUNTING PLATE, 9530-18

Optional mounting plate for standard hollow metal door frames. Specify length 36-1/2" to 101-1/2" maximum, when angle brackets. Specify length 33" to 98" maximum when using end dress plates.

NOTE: The length of a universal 18 plate will need to be ordered 3-1/2" longer than the supplied header when using angle brackets.

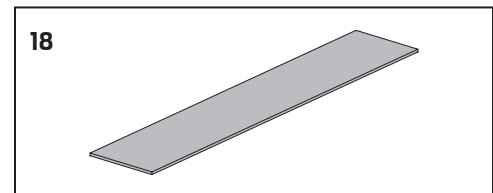

9530 SERIES

TABLE OF SIZES

DOOR WIDTH

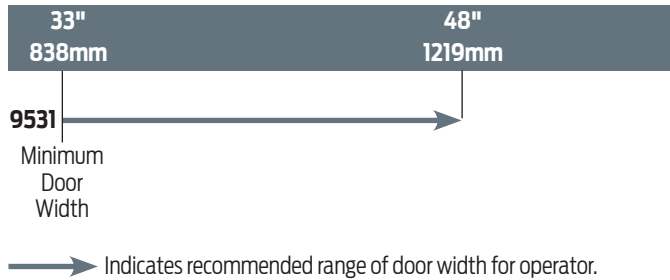

NOTE: For all Senior Swing Series.

Single Door - Width per leaf 33" minimum, 48" maximum.

HOW-TO-ORDER 9530 SERIES OPERATORS

1. SPECIFY HAND

RH

LH

2. SPECIFY HEADER/LENGTH

HL__ (Specify length 33" to 48")

DD__ (Specify length 49" to 98")

3. SPECIFY FINISH

Standard Anodized Finish _____
Aluminum or Dark Bronze.

Operator will be shipped with:

- STANDARD MOTOR GEARBOX,
- STANDARD CONTROL BOX,
- HEADER (at specified Length, 36" standard),
- STANDARD ARM (3077T),
- 2-3/4" PIVOT POINT,
- STANDARD TRACK w/TRACK ROLLER,
- MACHINE SCREW PACK

Unless options listed below are selected.

OPERATOR OPTIONS

MOUNTING PLATE

Plate,___ (Specify Length 33" to 101-1/2")

ORDERING INFORMATION

