

LCN 9740 SERIES

MOUNTING DETAILS

TOP JAMB SINGLE DOOR (OFFSET PIVOT/BUTT HINGE, CENTER PIVOT, PUSH) MOUNTING

Consult factory for all balance door installation.

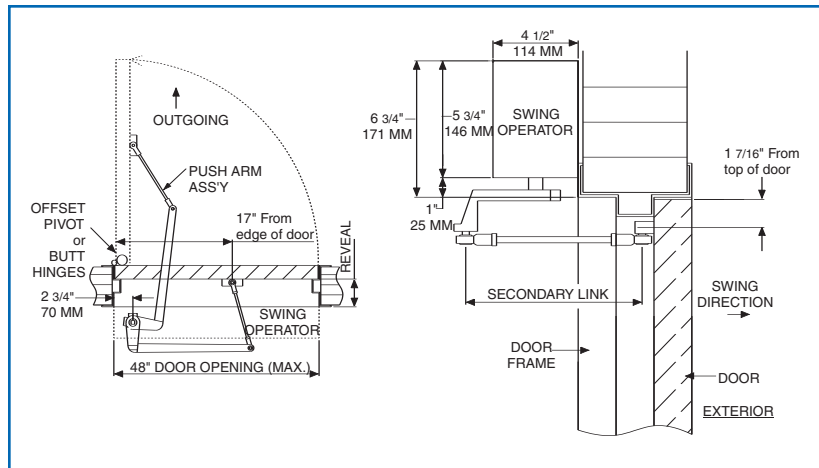

HOLLOW METAL FRAME

Suggested Installation

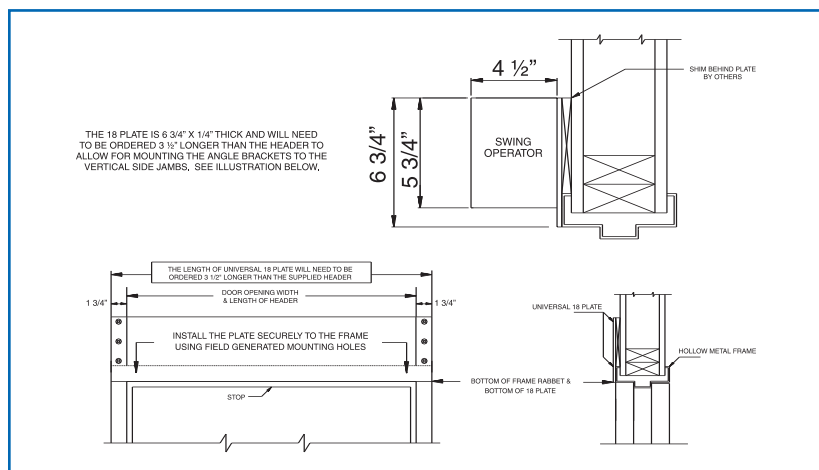

MAXIMUM OPENING

Template allows 90 degree power opening and 90 degree manual opening.

Special Templates

Customized installation templates or products may be available to solve unusual applications. Contact LCN for assistance.

- ▶ **Butt Hinges** should not exceed 5" (127 mm) in width.
- ▶ **Reveal** for push installations should not exceed 10" (254 mm) for REGULAR ARM and 20" (508 mm) for LONG ARM.
- ▶ **Head Frame** minimum 1 3/4" (44 mm). Face frame 6 3/4" (171 mm) total operator clearance.
- ▶ **Top Rail** minimum 2 3/4" (70 mm).
- ▶ **Opening & Closing Time** are variable by adjustments to the electronic control box. Maximum hold open time adjustable up to approximately 32 seconds.
- ▶ **System Diagram** see "AUTOMATIC OPERATORS" section pages 54-55 for typical system wiring and page 58 for electrical data.
- ▶ Please consult your local SSC representative or LCN for assistance with specific installations and material requirements.

MOTOR GEARBOX

MOTOR GEARBOX – MIDDLE SWING, 9740-3454

Driving mechanism for operator. Provides 8 1/2 lbs opening force. Handed.

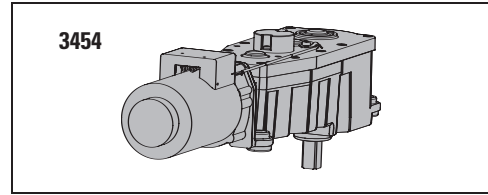

MOUNTING BRACKETS

MOUNTING BRACKET – 2 3/4", 9740-275

Motor gearbox mounting bracket for 2 3/4" offset pivot or butt hinge installations. Front bracket.

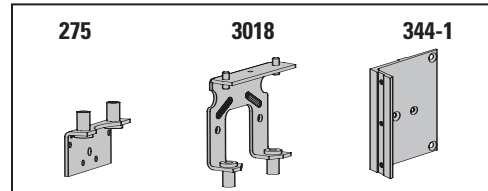

REAR MOUNT BRACKET, 9740-3018

Motor gearbox mounting bracket. Rear bracket.

ANGLED BRACKET, 9740-334-1

Mounting bracket for surface applications.

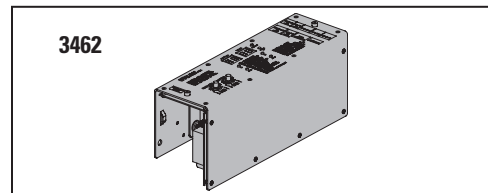

CONTROL BOXES

CONTROL BOX – MIDDLE SWING, 9740-3462

Electronic controlling device for Middle Swing.

HEADERS

Header, 9740-3572HL

Standard, mounting header. Single door, single operator. Specify length 33" to 49" maximum.

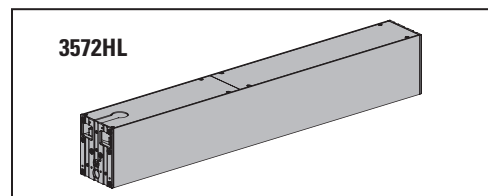

Header, 9740-3572DD

Standard, mounting header. Double door, single operator. Specify length 49" to 98" maximum.

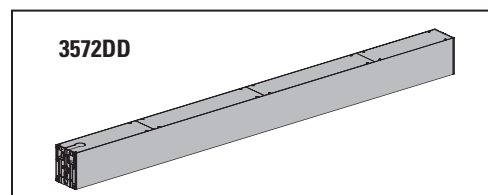

END CAPS

HEADER END CAPS, 9740-334

End cap with openings for wiring.

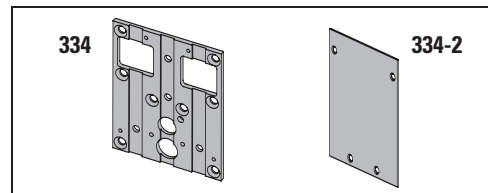

END DRESS PLATE, 9740-334-2

Metal finish end cap.

LCN 9740 SERIES

ACCESSORIES

ARMS

REGULAR ARM ASSEMBLY, 9740-3077

Handed arm.

REGULAR LONG ARM ASSEMBLY, 9740-3077L

Handed arm.

MAIN ARM, 9740 -77

Handed arm attaches to motor gearbox.

LINKAGE ASSEMBLY – 15", 9740-79

Threaded rod attaches to door. Extends from main arm.

LINKAGE ASSEMBLY – 32", 9740-79LR

Threaded long rod attaches to door. Extends from main arm.
Used for reveal 10" to 20".

INSTALLATION ACCESSORIES

SPINDLE PLATE – 2 3/4", 9740-11A

Hides bottom of motor gearbox. Completes header box. Cutout allows for motor gearbox shaft. For 2 3/4" offset pivot or butt hinge installations.

FILLER PLATE BLANK, 9740-12

Completes length of header box. (Specify Length)

MOUNTING PLATE, 9740-18

Optional mounting plate for standard hollow metal door frames. Specify length 33" to 98" maximum.

NOTE: The length of a universal 18 plate will need to be ordered 3 1/2" longer than the supplied header.

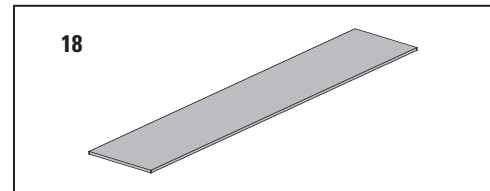
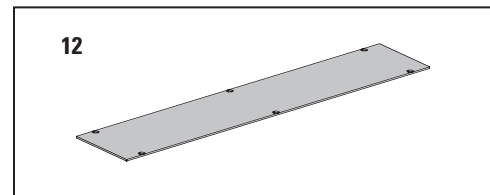
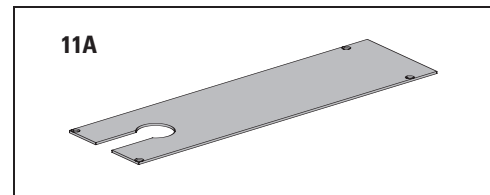
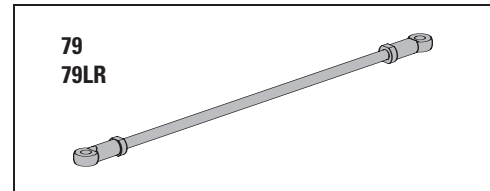
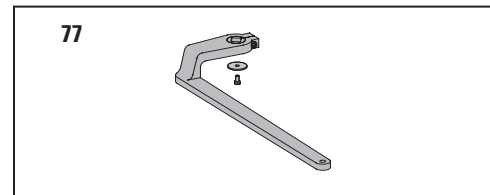
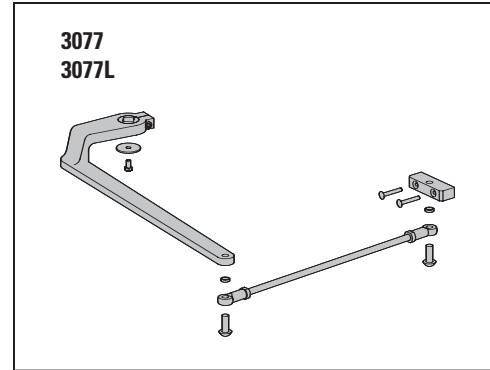
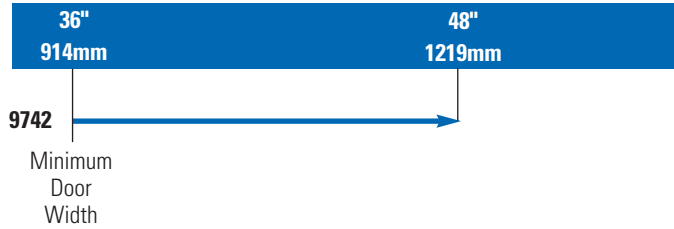

TABLE OF SIZES

→ Indicates recommended range of door width for operator.
 Note: For all Middle Swing Series
 Single Door - Width per leaf 36" minimum, 48" maximum

DOOR WIDTH



HOW-TO-ORDER 9740 SERIES OPERATORS

1. SPECIFY HAND

- RH
- LH

2. SPECIFY FINISH.

- Standard Anodized Finish _____
 Aluminum or Dark Bronze

Operator will be shipped with:

- STANDARD MOTOR GEARBOX (SF)
 - STANDARD CONTROL BOX (SC)
 - 36" HEADER (36HL)
 - STANDARD ARM (3077)
 - 2 3/4" PIVOT POINT
 - WOOD and MACHINE SCREW PACK
- Unless options listed below are selected.*

OPERATOR OPTIONS

HEADER

- HL __ (Specify length 36" to 49")
- DD__ (Specify length 49" to 98")

MOUNTING PLATE

- Plate, ____ (Specify Length 30" to 98")

ARM

- Long Arm (3077L)

FINISH

- Custom Anodized Finish _____
- Custom Painted Finish _____

SPECIAL TEMPLATE

- ST-_____