

Extra Heavy-duty overhead door holder/stop for single acting doors

HD7000 SERIES
SURFACE MOUNTED

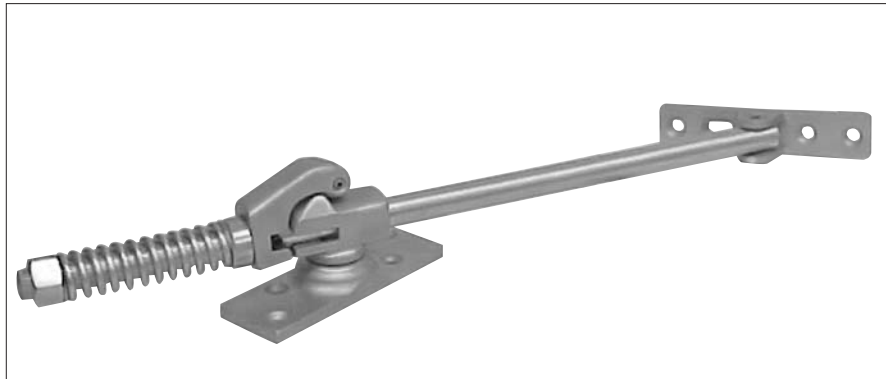

STANDARD FEATURES

- For heavy or wide doors, or doors in abusive conditions
- Non-handed/reversible
- Single point hold-open in increments of 5° from 85° to 110°
- Automatic hold-open and release by push and pull on door
- For stop only turn hook mechanism 90°, adjustable spring tension
- 5° to 7° shock compression following hold-open point
- Maximum opening 110°, minimum door thickness 1 3/4"
- Wood, machine screws and sex bolts included
- Available in sprayed finishes.

**All Stops
Warnock Hersey
listed**

**WHEN ORDERING,
please list:**

Model number

Door closer number or other hardware

Mounting means of the door and butt size

Hold-open or dead-stop degree

Door opening and thickness

Finish

SPECIFICATIONS:

Stop only function to be Warnock Hersey listed as manufactured by ABH.

*Material:
Bar 3/4" steel bar; jamb bracket malleable cast iron; adjustable hold-open tension.*

DOOR FRAME OPENING		HOLDER NUMBER	
BUTTS OFFSET PIVOTS	CENTER HUNG	HOLD OPEN	STOP
24" - 29 15/16"	26" - 31 15/16"	HD7010	HD7020
30" - 35 15/16"	32" - 38 15/16"	HD7011	HD7021
36" - 39 15/16"	39" - 42 15/16"	HD7012	HD7022
40" - 47 15/16"	43" - 50 15/16"	HD7013	HD7023
48" + Greater	51" + Greater	HD7014	HD7024
BHMA NUMBER		C08511	C08541
FED. SPEC TYPE		GJ70	GJ70

Contact ABH for special templating or other door opening
Average weight/unit 10 lbs.

www.abhmfg.com
E-mail: abhinfo@abhmfg.com
Architectural Builders Hardware Mfg., Inc.
1222 Ardmore Ave., Itasca, IL 60143
630.875.9900; FAX 800.9FAXABH (932.9224)

© 2005 ABH Mfg., Inc.
Printed in USA 02/05

