

MODEL FA-200

Indicating Shunt Switch

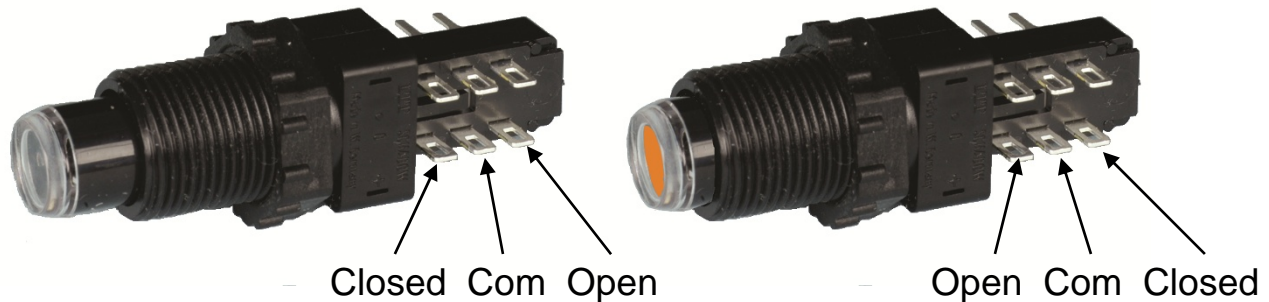

- DPDT Alternate Action Pushbutton (Can be Converted to Momentary Operation)
- Contacts Rated 2A @ 28VDC
- Indicator Changes to Orange When Depressed
- Provided With Solder Terminals
- Mounts in 9/16" Diameter Hole
- Black Plastic Dress Nut and Lock Nut
- White, Red, Blue and Black 11C Guard Rings are Available
- See Model RP-44 For FA-200 Mounted On Stainless Steel Electrical Plate



Alarm Controls
19 Brandywine Drive
Deer Park, New York 11729
(800) 645-5538
www.alarmcontrols.com

ASSA ABLOY, the global leader
in door opening solutions

Convert an FA-200 Switch from Alternate Action to Momentary Operation

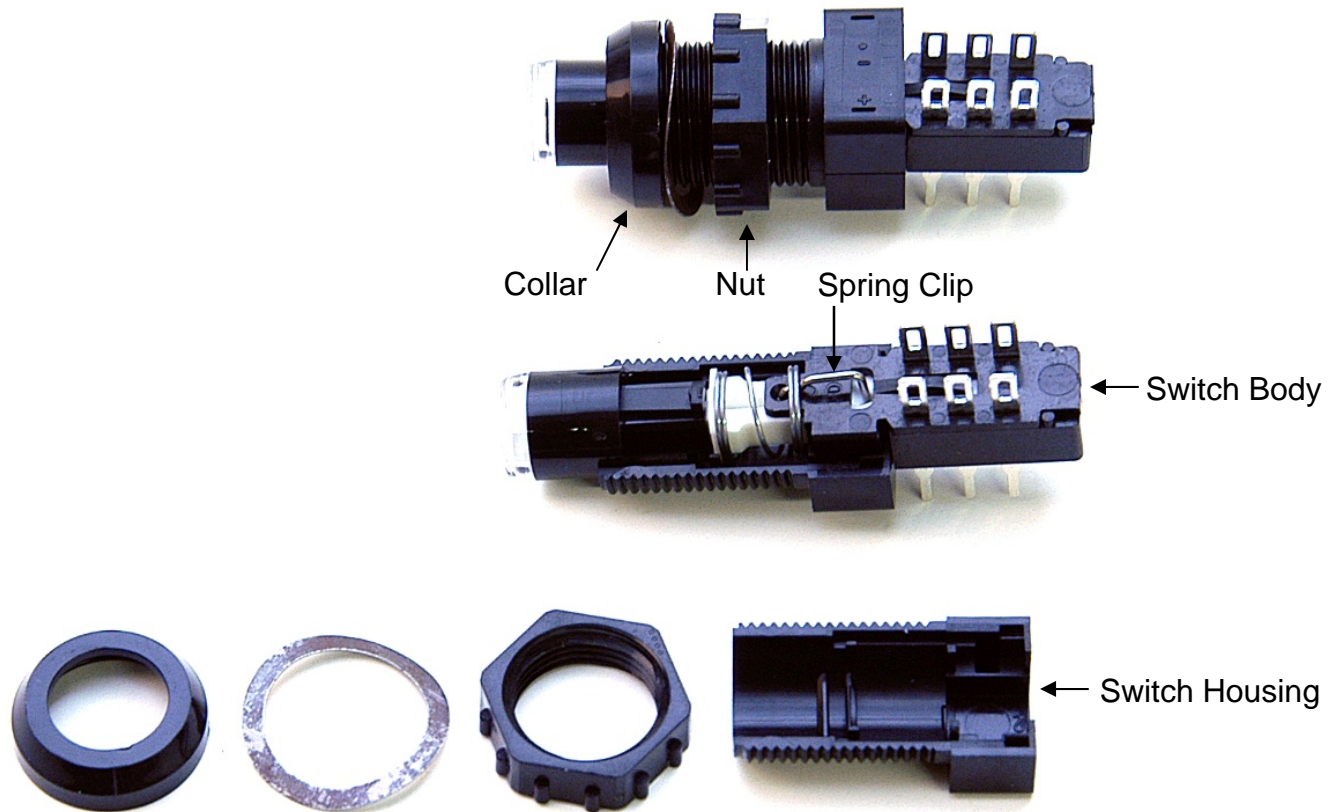

1. Unscrew the collar, washer and nut and remove them from the switch housing.
2. Lift the top half of the switch housing from the switch body.
3. Remove the spring clip.
4. Re-assemble the switch.