

**Notes:**

1. Do not scale drawing.
2. Right hand shown.
3. Suitable reinforcing by others.
4. Pivots drilled for 1/4-20 x 5/8 FHMS or #14 x 1-1/2 FHWS.
5. When jamb portion is installed on top of threshold allow for threshold height when preparing frame and door mortise depth.
6. All dimensions are in inches (mm).

DISTRIBUTED BY  

 ACCESS HARDWARE SUPPLY  
[accesshardware.com](http://accesshardware.com)

**Pivot Set**  
**3/4" Offset, Handed**

**RIXSON®**  
**ASSA ABLOY**  
[www.rixson.com](http://www.rixson.com)

NUMBER	DATE
<b>IS-195</b>	<b>07-09</b>

# 195 Pivot Set

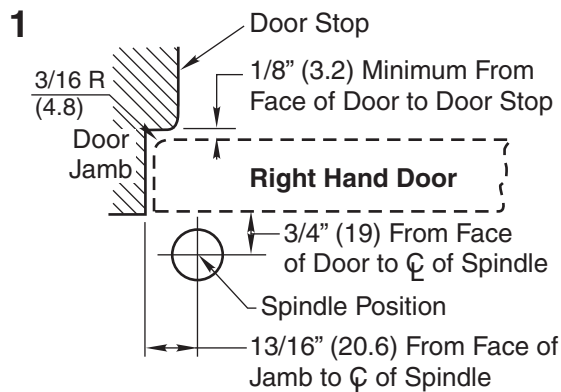

## 1. Install Pivot

- Measure 13/16" (20.6) out from door jamb.
- Allow 1/8" (3.2) min. clearance from door stop to door face. Measure door thickness. Add 3/4" (19).
- Where lines meet determines center line of closer.

## 2. Set Pivot Set

- Mortise jamb to receive jamb leaf as shown on reverse side.
- Care must be exercised to see that pivot end of jamb leaf is level. Place levels as per illustration.

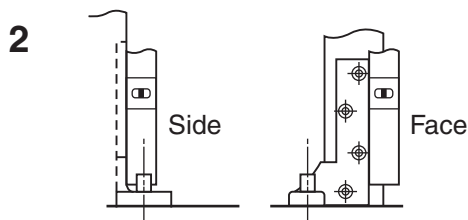

## 3. Install Top Pivot & Pivot Arm

- Install top pivot in door per template.
- Install top pivot in frame per template.
- Install arm in door per template.
- Center line of pivot should line up with center line of spindle. Use plumb line as illustrated.
- If side jamb pivot is used, see required template.

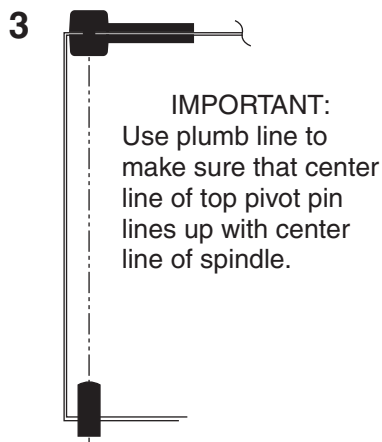

## 4. Hang Door

- Set door on pivot set spindle.
- Push Item 1 "top pivot pin" into place. Attach "cap" Item 2.
- If door drags at floor (or threshold, if used) loosen arm locking screw and raise door to desired clearance and insert one or more 1/16" (1.6) shims. Retighten arm locking screw securely.
- Put arm cap on arm and secure tightly with cap screw furnished.

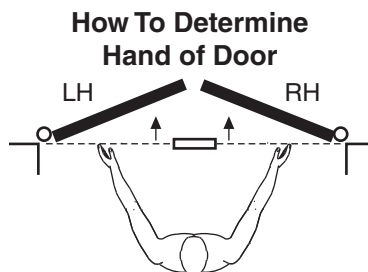
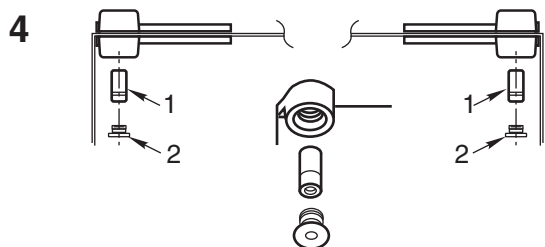

Face a door swinging open away from you.  
 If it opens to the right, it is right hand. If it opens to the left, it is left hand.

**Pivot Set**  
**3/4" Offset, Handed**

DISTRIBUTED BY  
**AHS** ACCESS HARDWARE SUPPLY  
[accesshardware.com](http://accesshardware.com)

**RIXSON®**  
**ASSA ABLOY**

[www.rixson.com](http://www.rixson.com)

NUMBER

**IS-195**

DATE

**07-09**