

# 9540 SERIES

## FEATURES

### SINGLE DOOR, SURFACE MOUNT (PUSH) OFFSET PIVOT/BUTT HINGE

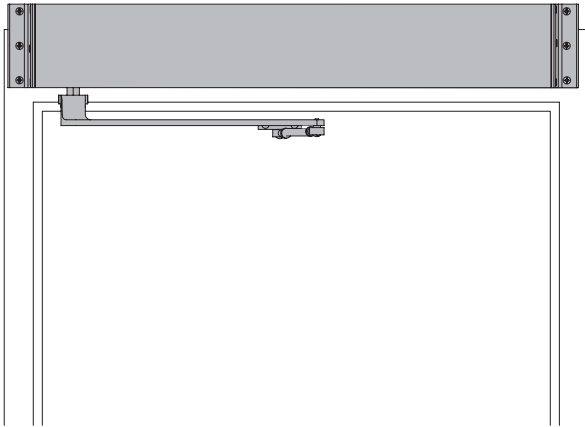

The 9540 SENIOR SWING by LCN is an ADA door operator that is a two-in-one swing door operator. SENIOR SWING operators when activated, opens doors automatically for wheelchair access, yet allows for manual operation for regular pedestrian traffic.

- Push 'N Go permits non-switch activation.
- Power Boost provides additional latching force.
- Electromechanical unit with microprocessor control.
- Digital keypad for easy setup.
- Meets International Building Code requirements and ANSI A156.19.
- UL approved for fire doors.

*9540 Series is fully compliant with UL 325 & UL 1998 and meets the provisions of ANSI A156.19. The 9540 Series is UL listed for fire-rated applications. The 9540 Series also meets the provisions of the Americans with Disabilities Act.*

- 9540 Series operator is shipped with motor gearbox, control box, regular arm, header, and mounting hardware. Actuators available separately, see pages 122-137.
- Single door, surface mounted.
- Meets ADA requirements (power mode only).
- Handed product.
- 36" header length is standard. Specify length 33" to 48" max.
- Double door header available up to 98", specify other length 49" to 98" max. Consult factory regarding this option.
- Adjustable hold open period of 2 to 32 seconds in automatic or manual mode.

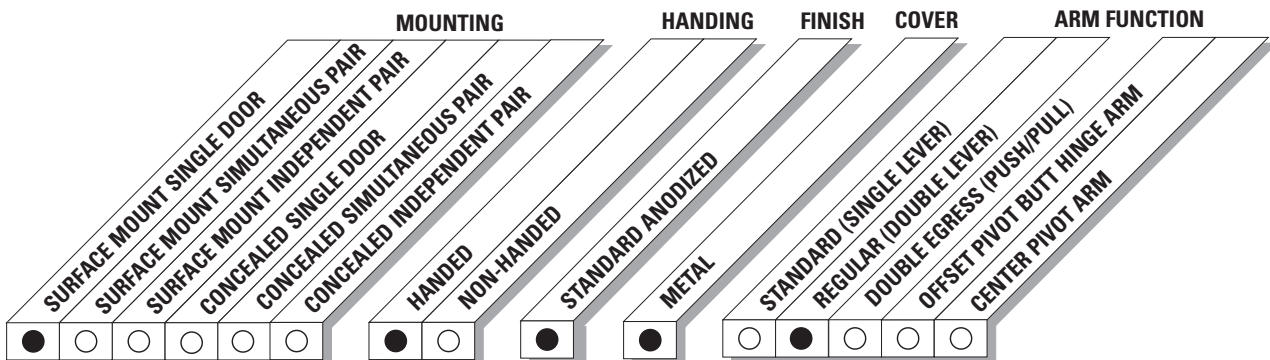

● AVAILABLE  
○ NOT AVAILABLE

DISTRIBUTED BY  
**AHS** ACCESS HARDWARE SUPPLY  
accesshardware.com

PHONE 877-671-7011  
FAX 800-248-1460  
www.allegion.com/us  
2/14

# 9540 SERIES

## TOP JAMB SINGLE DOOR (OFFSET PIVOT/BUTT HINGE, CENTER PIVOT, PUSH) MOUNTING

Consult factory for all balance door installations.

### HOLLOW METAL FRAME

Suggested Installation.

### MAXIMUM OPENING

Template allows 90 degree power opening and 90 degree manual opening.

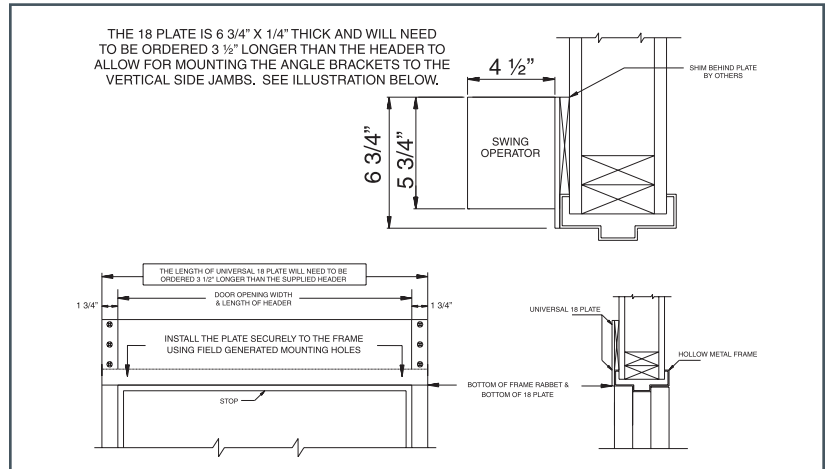
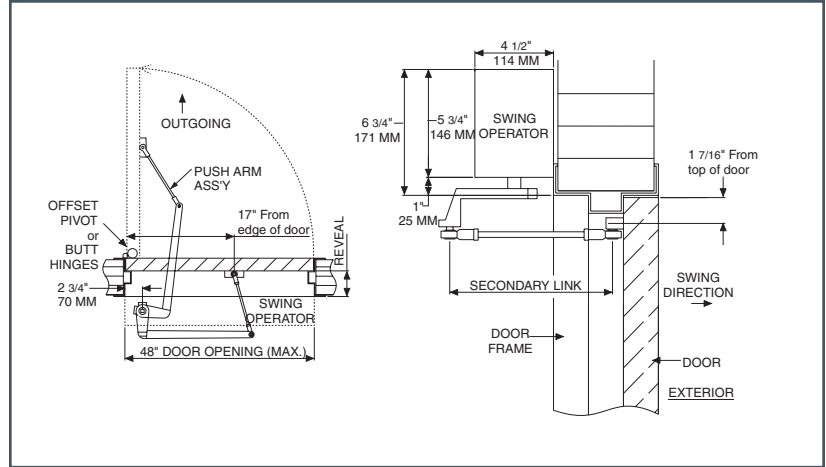

- **Butt Hinges** should not exceed 5" (127 mm) in width.
- **Reveal** for push installations should not exceed 10" (254 mm) for REGULAR ARM and 20" (508 mm) for LONG ARM.
- **Head Frame** minimum 1-3/4" (44 mm). Face frame 6-3/4" (171 mm) total operator clearance.
- **Top Rail** minimum 2-3/4" (70 mm).
- **Opening & Closing Time** are variable by adjustments to the electronic control box. Maximum hold open time adjustable up to approximately 32 seconds.
- **System Diagram** see "AUTOMATIC OPERATORS" section pages 53 for typical system wiring and page 56 for electrical data.

Contact LCN Product Support for installation assistance.

# 9540 SERIES

## MOTOR GEARBOX

### MOTOR GEARBOX – SENIOR SWING, 9540-3454

Driving mechanism for operator. Provides 15 lbs opening force. Handed.

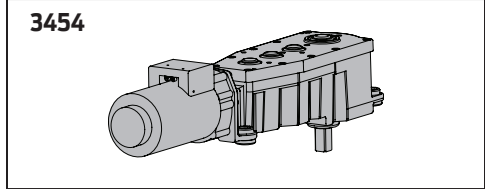

## MOUNTING BRACKET

### MOUNTING BRACKET – 2-3/4", 9540-275

Motor gearbox mounting bracket for 2-3/4" offset pivot or butt hinge installations. Front bracket.

### REAR MOUNT BRACKET, 9540-3018

Motor gearbox mounting bracket. Rear bracket.

### ANGLED BRACKET, 9540-334-1

Mounting bracket for surface applications. (Includes 2 mounting brackets).

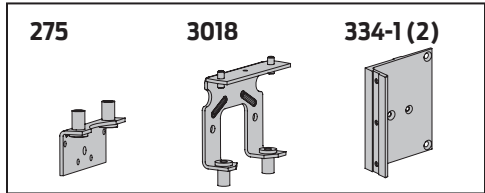

## CONTROL BOXES

### CONTROL BOX – SENIOR SWING, 9540-3462

Electronic controlling device for Senior Swing.

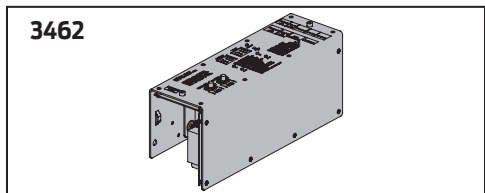

## HEADERS

### Header, 9540-3572HL

Standard, mounting header. Single door, single operator. Specify length 33" to 48" maximum.

### Header, 9540-3572DD

Standard, mounting header. Double door, single operator. Specify length 49" to 98" maximum.

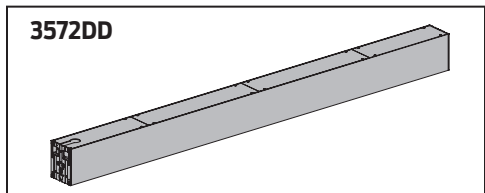
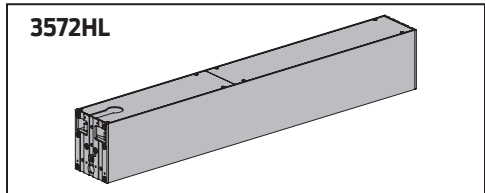

## END CAPS

### HEADER END CAPS, 9540-334

End cap with openings for wiring.

### END DRESS PLATE, 9540-334-2

Metal finish end cap.

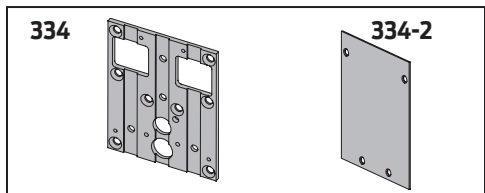

# 9540 SERIES

## ARMS

### REGULAR ARM ASSEMBLY, 9540-3077

Handed arm.

### REGULAR LONG ARM ASSEMBLY, 9540-3077L

Handed arm.

### MAIN ARM, 9540-77

Handed arm attaches to motor gearbox.

### LINKAGE ASSEMBLY – 15", 9540-79

Threaded rod attaches to door. Extends from main arm.

### LINKAGE ASSEMBLY – 32", 9540-79LR

Threaded long rod attaches to door. Extends from main arm.  
Used for reveal 10" to 20".

## INSTALLATION ACCESSORIES

### SPINDLE PLATE – 2-3/4", 9540-11A

Hides bottom of motor gearbox. Completes header box. Cutout allows for motor gearbox shaft. For 2-3/4" offset pivot or butt hinge installations.

### FILLER PLATE BLANK, 9540-12

Completes length of header box. (Specify length).

### MOUNTING PLATE, 9540-18

Optional mounting plate for standard hollow metal door frames. Specify length 36-1/2" to 101-1/2" maximum, when angle brackets. Specify length 33" to 98" maximum when using end dress plates.

*NOTE: The length of a universal 18 plate will need to be ordered 3-1/2" longer than the supplied header when using angle brackets.*

3077  
3077L

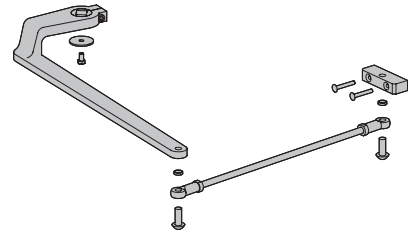

77

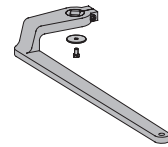

79  
79LR

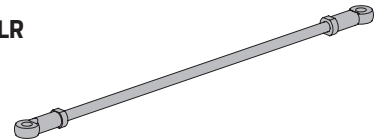

11A

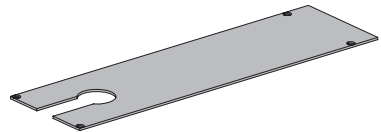

12

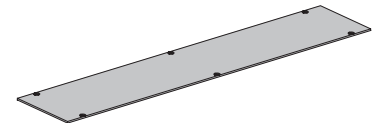

18

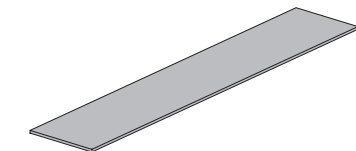

# 9540 SERIES

## TABLE OF SIZES

### DOOR WIDTH

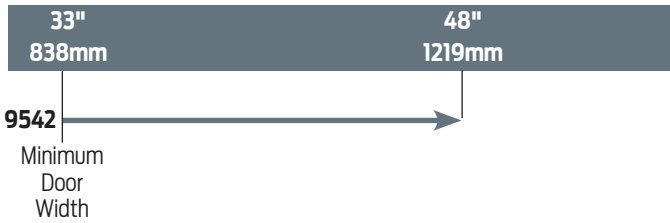

→ Indicates recommended range of door width for operator.

NOTE: For all Senior Swing Series.

Single Door - Width per leaf 33" minimum, 48" maximum.

## HOW-TO-ORDER 9540 SERIES OPERATORS

### 1. SPECIFY HAND

RH

LH

### 2. SPECIFY HEADER/LENGTH

HL\_\_ (Specify length 33" to 48")

DD\_\_ (Specify length 49" to 98")

### 3. SPECIFY FINISH

Standard Anodized Finish \_\_\_\_\_  
Aluminum or Dark Bronze.

### Operator will be shipped with:

- STANDARD MOTOR GEARBOX,
  - STANDARD CONTROL BOX,
  - HEADER (at specified length, 36" standard),
  - REGULAR ARM (3077),
  - 2-3/4" PIVOT POINT,
  - WOOD and MACHINE SCREW PACK
- Unless options listed below are selected.*

## OPERATOR OPTIONS

### MOUNTING PLATE

Plate, \_\_\_ (Specify Length 33" to 101-1/2")

### ARM

Long Arm (3077L)

ORDERING INFORMATION

