

BACKSET	"A" DIM.	"B" DIM.
1-1/8"	1.12	1.76
1-1/2"	1.50	2.13

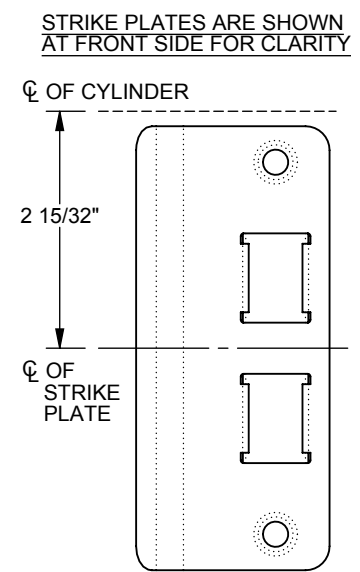

5 FOR TRADITIONAL MOUNTING INSTALLATIONS

- MEASURE THE DEPTH FROM THE BACK OF THE STILE TO THE INSIDE WALL OF DOOR EDGE.
- MATCH THE DISTANCE FROM THE FACE OF MOUNTING PLATE TO END OF TUBE SPACER.
- USE 3/16" HEX KEY FOR FINE ADJUSTMENT.

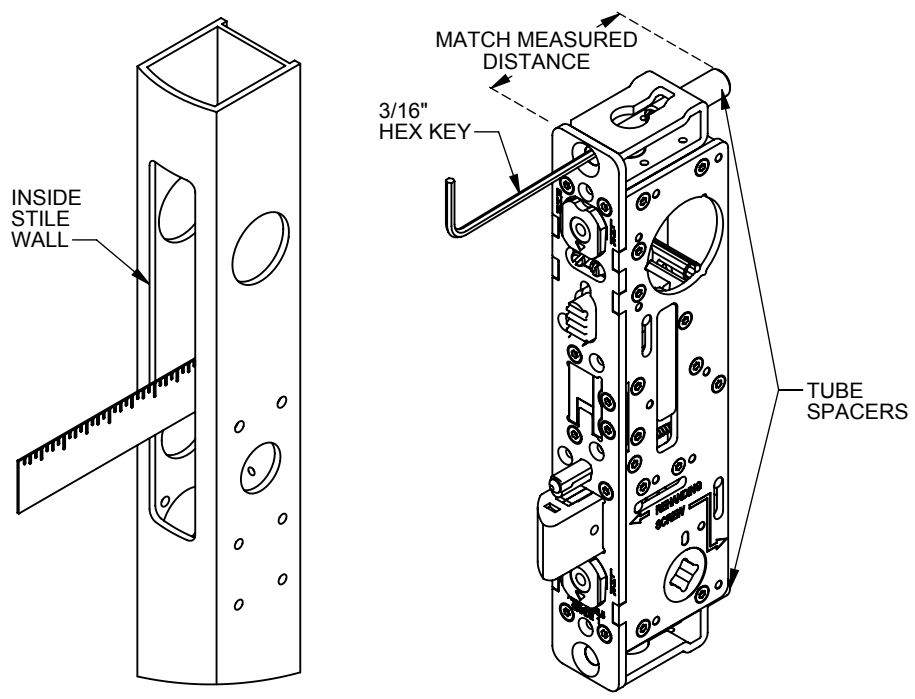

6 FOR MOUNTING TAB INSTALLATIONS

- REMOVE TOP AND BOTTOM FLAT HEAD UNDERCUT SCREW #8-32 x 1/4" AS SHOWN. THEN REMOVE YOKE. (MOUNTING TABS NOT INCLUDED).

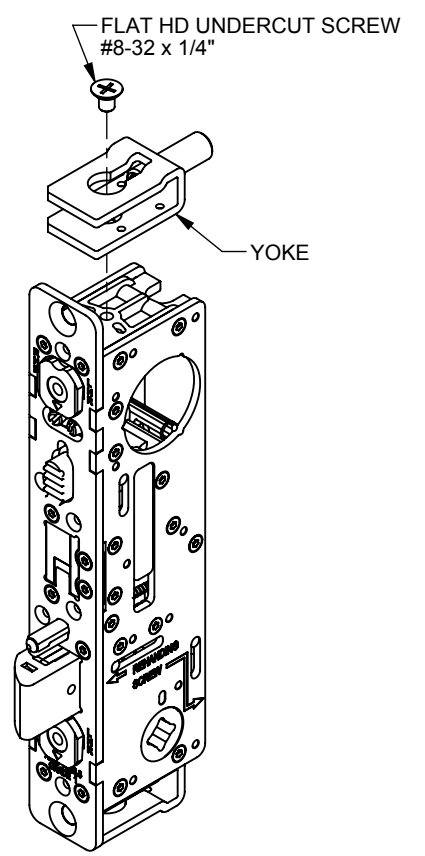

7 INSTALLING LOCK

- INSERT LOCK ASSEMBLY INTO STILE THRU CUTOUT.
- INSTALL AND FASTEN TWO (2) FLAT HEAD SCREWS #10-32 x 1-7/8" TO SECURE THE LOCK ASSEMBLY ON STILE.

8 - INSTALL CYLINDER AND SECURE WITH SET SCREWS.
- INSTALL FACE PLATE.

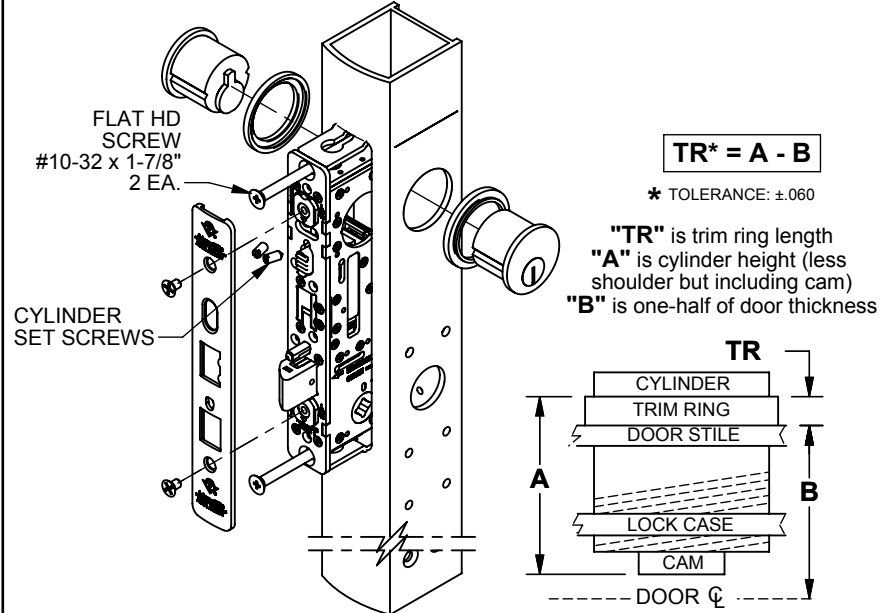

9 HANDING CONFIGURATION FOR 2190 TRIM

- THE OUTPUT DRIVE FOR THE EXTERIOR TRIM IS SHIPPED FROM THE FACTORY WITH A CLOCKWISE ROTATION AND THE INTERIOR TRIM IS SHIPPED WITH A COUNTER-CLOCKWISE ROTATION. TO CHANGE THE OUTPUT DRIVE ROTATION, FOLLOW THESE STEPS:
- 1. REMOVE THE SHOULDER SCREW WITH A 5/64" ALLEN WRENCH.
- 2. REINSTALL SHOULDER SCREW ON THE OPPOSITE SIDE.

REFER TO THE CHART BELOW FOR REHANDING THE TRIM AS NEEDED.

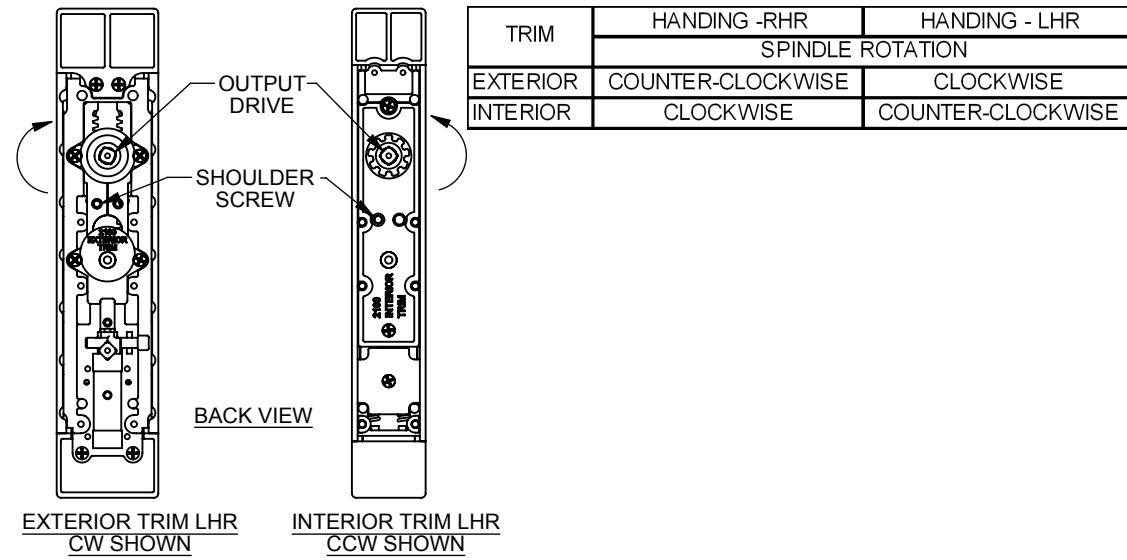

10 ASSEMBLE EXTERIOR TRIM

- SLIDE THE FINISH COVER ONTO BODY. THE COVER HAS CUTOUTS THAT FIT OVER THE GROOVES ON THE BODY.
- INSTALL BOTTOM CAP WITH (2) FLAT HEAD SCREWS (#4-40 x 1/4") SUPPLIED.
- INSTALL TOP CAP WITH (2) FLAT HEAD SCREWS (#4-40 x 1/4") SUPPLIED.

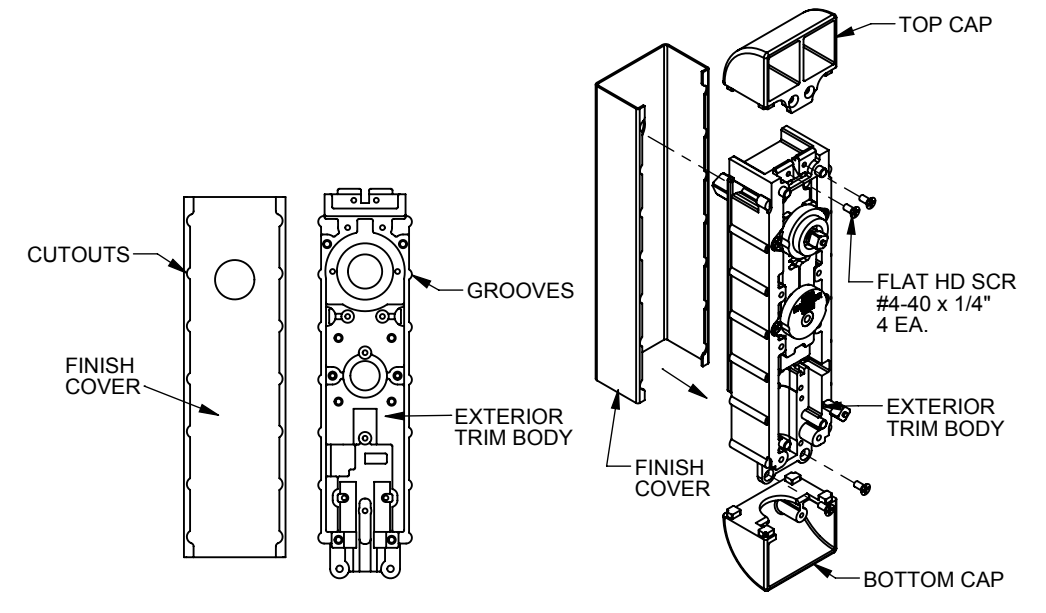

11 INSTALLING INTERIOR & EXTERIOR TRIM TO STILE

- INSERT DRIVE SPINDLE INTO EACH TRIM BODY PRIOR TO MOUNTING.

- MOUNT THE EXTERIOR TRIM AND INTERIOR TRIM BODY TO THE STILE USING (6) #6-32 x 3" FLAT HEAD SCREWS.

- SLIDE THE COVER ONTO INTERIOR TRIM BODY FROM THE TOP.

- INSERT SHAFT THRU THE HOLE ON THE COVER AND THE OUTPUT ON TRIM BODY. THE GROOVE ON THE SHAFT FACES OPPOSITE THE LATCH BOLT. TIGHTEN THE SET SCREW WITH A 3/32" ALLEN WRENCH TO SECURE THE SHAFT AS SHOWN IN FIG. 2.

- INSTALL TOP CAP USING (2) #4-40 x 1/4" FLAT HEAD SCREWS.

- PUSH THE COVER UP FLUSH WITH THE TOP CAP. INSTALL BOTTOM CAP USING (2) #6-32 x 3/8" FILLISTER HEAD SCREWS.

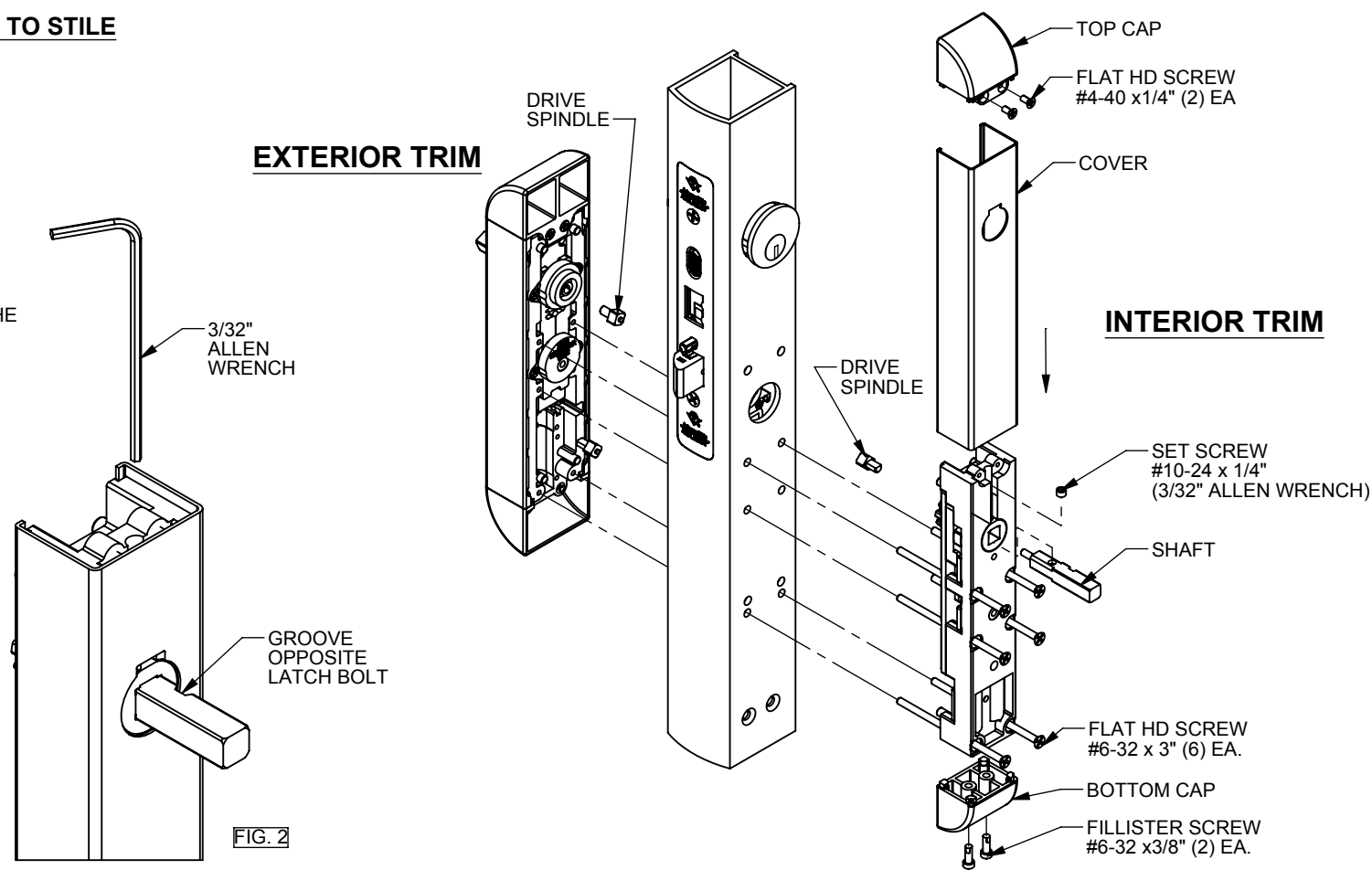

12 INSTALLING HANDLE (INTERIOR / EXTERIOR)

- INSERT WASHER THEN INSERT HUB OVER SHAFT. ON MODELS 2190-01, 2190-02, 2190-03, THE HUB IS FACTORY INSTALLED. REMOVE LOCK SCREW WITH 1/8" ALLEN WRENCH AND PROCEED TO NEXT STEP.

- INSTALL HANDLE OVER THE HUB WITH THE HOLE ALIGNED WITH THE HOLE ON THE HUB.

NOTE: THE SHAFT DETENT SHOULD BE ALIGNED WITH THE LOCKING SCREW.

- MOVE THE HANDLE IN UNTIL IT IS AGAINST THE TRIM COVER.
- FASTEN THE LOCK SCREW 26-0933 TO SECURE THE HANDLE WITH 1/8" ALLEN WRENCH.

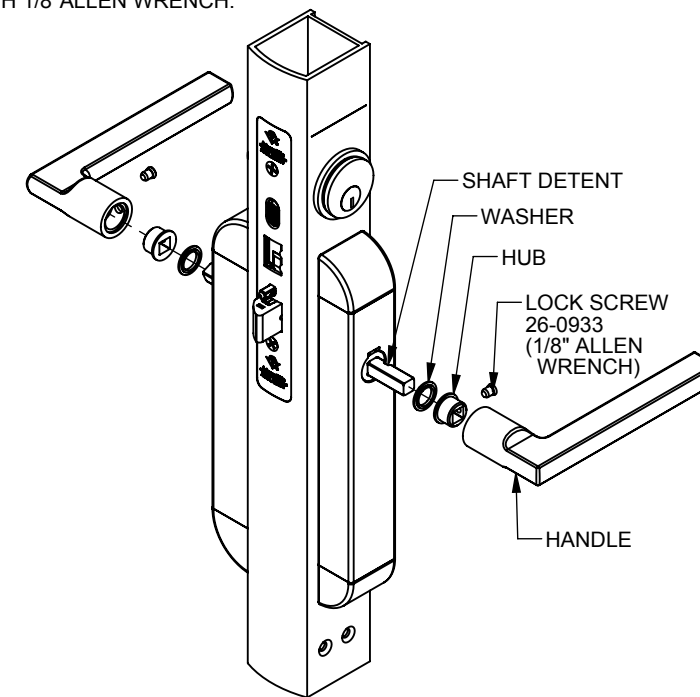

LATCH HOLD BACK FEATURE

- IN THE LOCK POSITION, INSERT KEY, TURN KEY 180° TO RETRACT THE DEADBOLT.

- TURN KEY 315° TO RETRACT THE LATCHBOLT.

- HOLD IN THIS POSITION AND PUSH DOWN THE HOLD BACK BUTTON TO RETAIN LATCHBOLT.

- RETURN KEY TO NEUTRAL POSITION AND REMOVE KEY.

TO RELEASE HOLD BACK

- INSERT KEY, TURN KEY OR THUMB TURN ABOUT 135° AND HOLD.

- PUSH UP THE HOLD BACK BUTTON TO RELEASE THE LATCH BOLT.

- RETURN KEY TO THE NEUTRAL POSITION AND REMOVE KEY.

TEST OPERATION

- EXTEND DEADBOLT WITH KEY OR THUMBTURN.

- PUSH DOWN ON INTERIOR LEVER. THE DEADBOLT AND LATCH SHOULD FULLY RETRACT.

- IF LATCH ONLY RETRACTS - REFER TO STEP 4 FOR INTER-CONNECTION CONFIGURATION.

- IF NEITHER RETRACT - REFER TO STEP 11 FOR DRIVE SPINDLE INSTALLATION.

- PUSH DOWN ON EXTERIOR LEVER - THE LATCH ONLY SHOULD RETRACT.

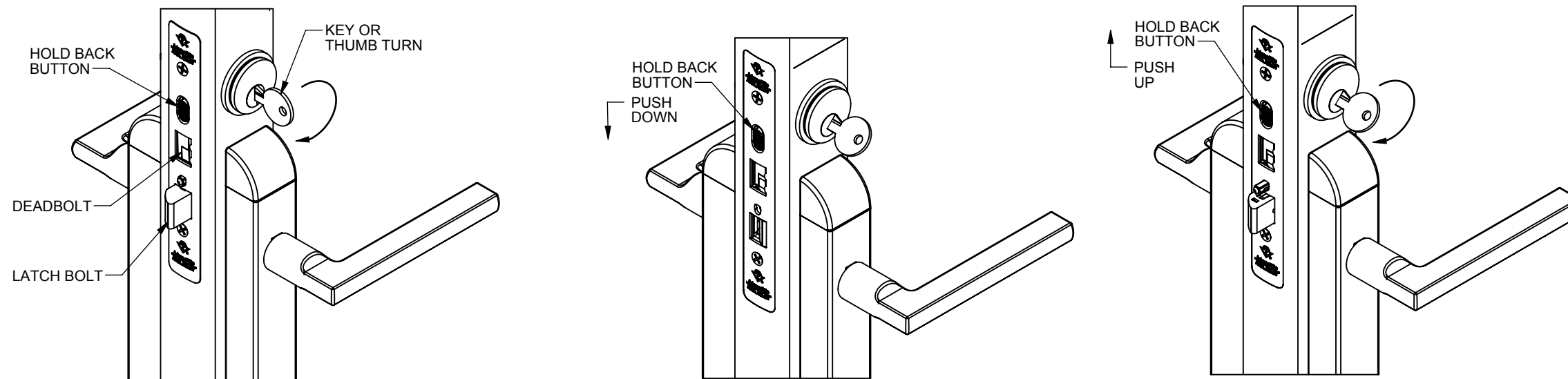

**PRODUCT MUST BE INSTALLED
ACCORDING TO ALL APPLICABLE
BUILDING AND LIFE SAFETY CODES**