

NOTE: Depending on models ordered, delay times may vary



- SPECIAL NOTES and DEFINITIONS**
- The door needs to be closed to test the unit.
 - When operating the ON/OFF switch, there is a slight delay.
 - The key is inserted and removed only in the vertical position (home position).
 - Key function: counter clockwise (CCW) = Armed; clockwise (CW) = Disarmed
 - The power needs to be disconnected to register changes in the slide switches.
 - Status Indicator (This will affect battery life on battery only installations AND/OR if building power is lost)
 - Disable Auto Rearm
 - Lo Bat Disable (AC powered units only)
 - There will be resistance turning key CCW. Turn through resistance.

UNIT ARMING TEST:

- Turn key counterclockwise (CCW) (key is removable after rotating back to vertical position)
- Red LED will flash twice, then green LED will illuminate for the 15 second delay time, then turn off. The siren will sound three short beeps indicating the unit is armed.
- Open door (Siren will sound and red LED will illuminate)
- Turn key clockwise (CW). Turns alarm off.

TAMPER SWITCH

- All four mounting screws must be installed as per the installation instructions.
- Once the unit is armed, removal of the screw holding the tamper switch will cause the unit to go into alarm.

LOW BATTERY ALERT:

- Siren will beep and red LED will blink at approximately 45 second intervals when battery is low
- Disconnect power, slide the "Lo Bat Disable" switch towards the green terminal block to disable the low battery alert on AC powered units.

STATUS INDICATOR

- Disconnect power, slide the switch to ON and then, apply power.
- If the unit is armed, the red LED will blink.
- If the unit is disarmed, the green LED will blink.

Disable AUTO REARM

- Disconnect power, slide switch to OFF and then, apply power.
- Once the unit is in full alarm and the door closes, the alarm will rearm after 2 minutes.

REMOTE

- Terminals 3 & 4 of the terminal block can be connected to a normally open switch.
- Actuating this switch will allow authorized door access from a remote location.

CALL BELL

- Terminals 7 & 8 of the terminal block can be connected to a normally open switch.
- Actuating the switch will cause a (3) second actuation of the siren.
- This feature is available in both armed and disarmed states.

Relay Table (Remote Signal)	
Pin 10	Common
Pin 11	Normally Open
Pin 12	Normally Closed

Contacts rated at 1.0A @ 30VDC or 0.5A @ 128VAC

Table 1. Signal relay

Figure 5: KEY STOP INSTALLATION
(Key stop included in hardware kit)

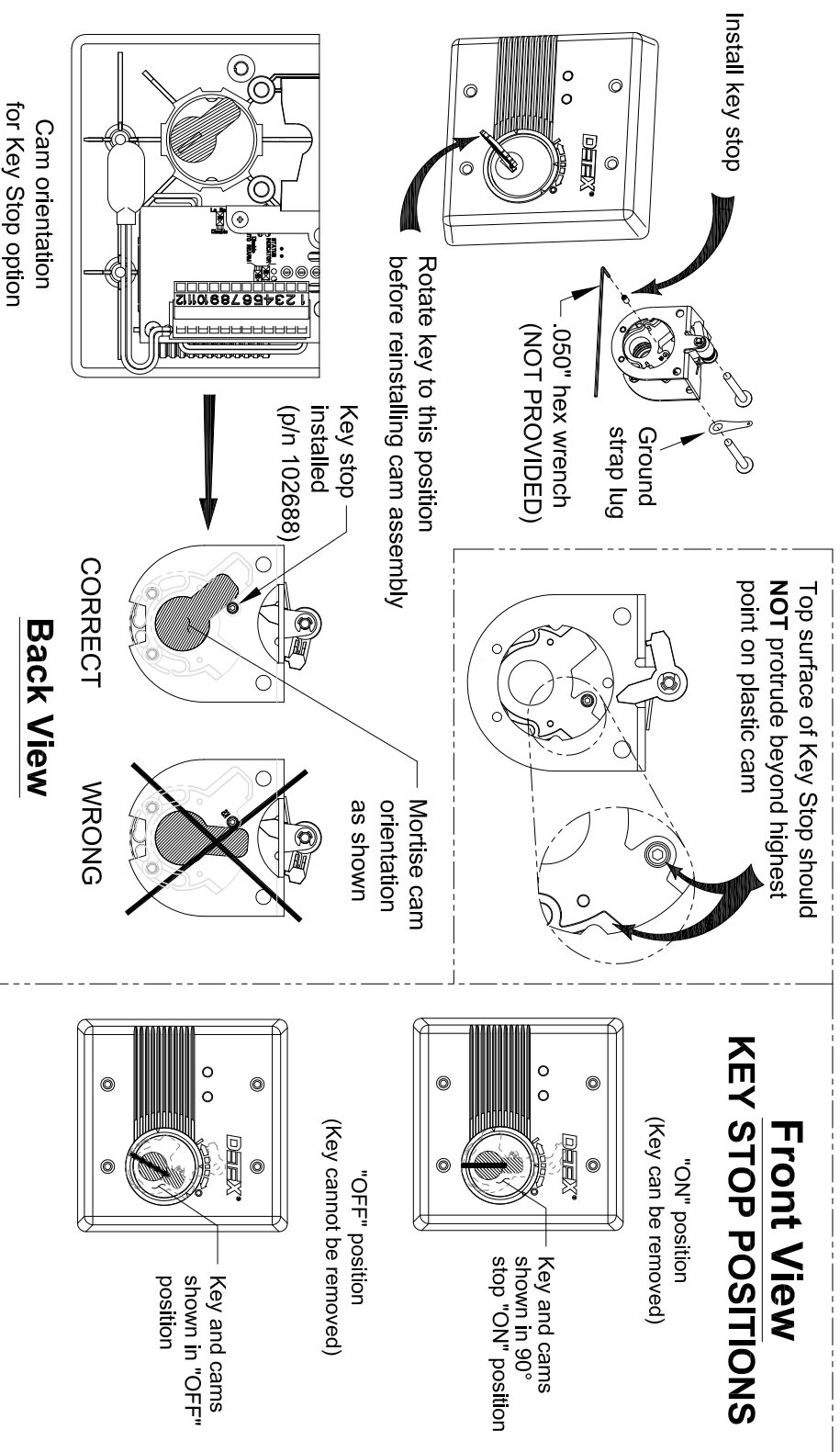

INSTALLATION INSTRUCTIONS FOR EAX-2500 EXIT ALARM

Detex Corporation, 302 Detex Drive, New Braunfels, Texas 78130-3045
(830)629-2900 / 1-800-729-3839 / Fax (830)620-6711
E-MAIL: detex@detex.com INTERNET: www.detex.com

SI=Status Indicator
L9=Less 9V Battery

Magnetic Switch Position:
The preferred position of the magnetic switch is the top of the door, centered approx 6" from the edge of door, as shown.

Alternate magnetic switch position:

Use magnetic switch contacts that are closed when door is secure. See magnetic switch documentation for more info.

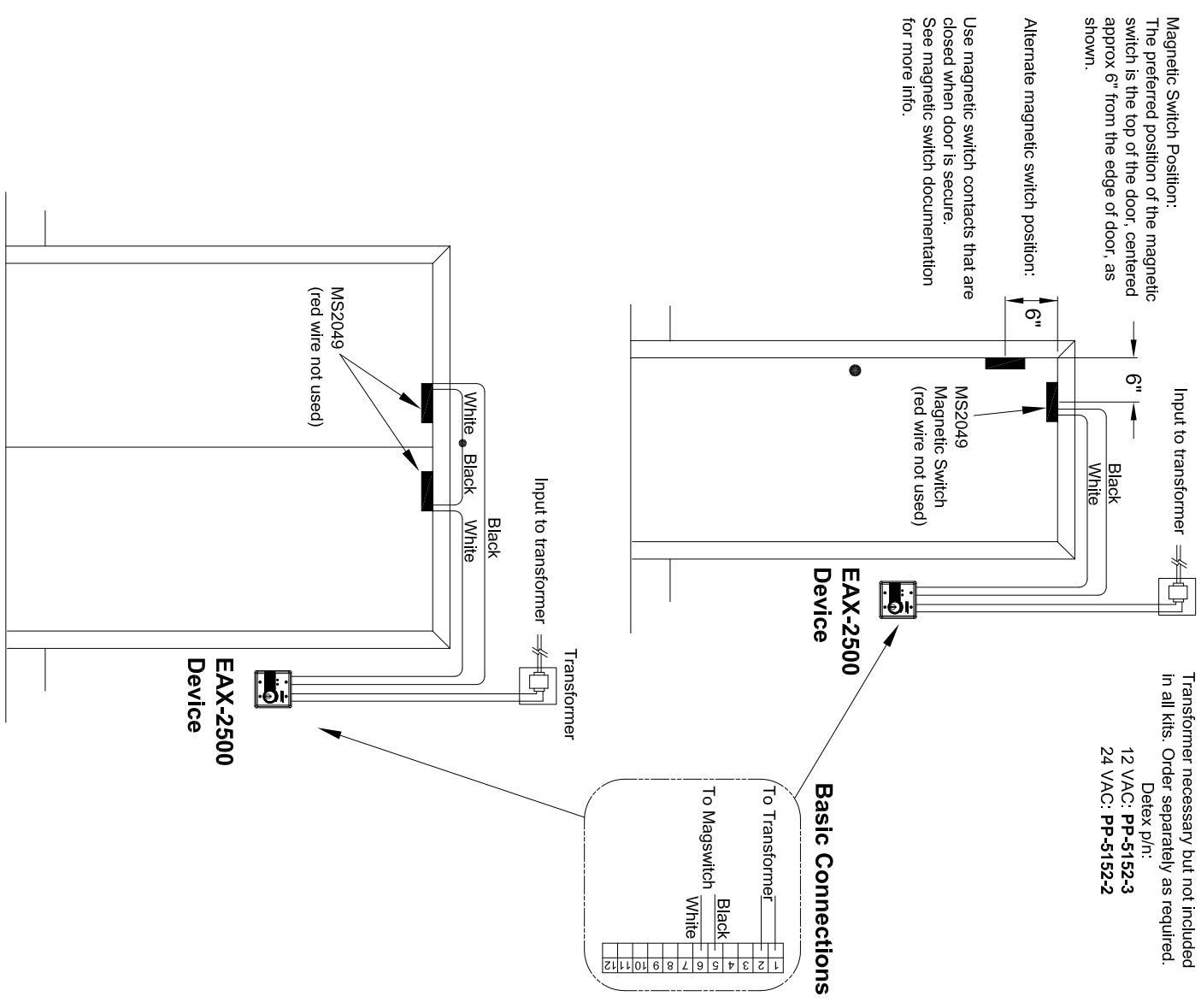

EAX-2500 INSTALLATION INSTRUCTIONS

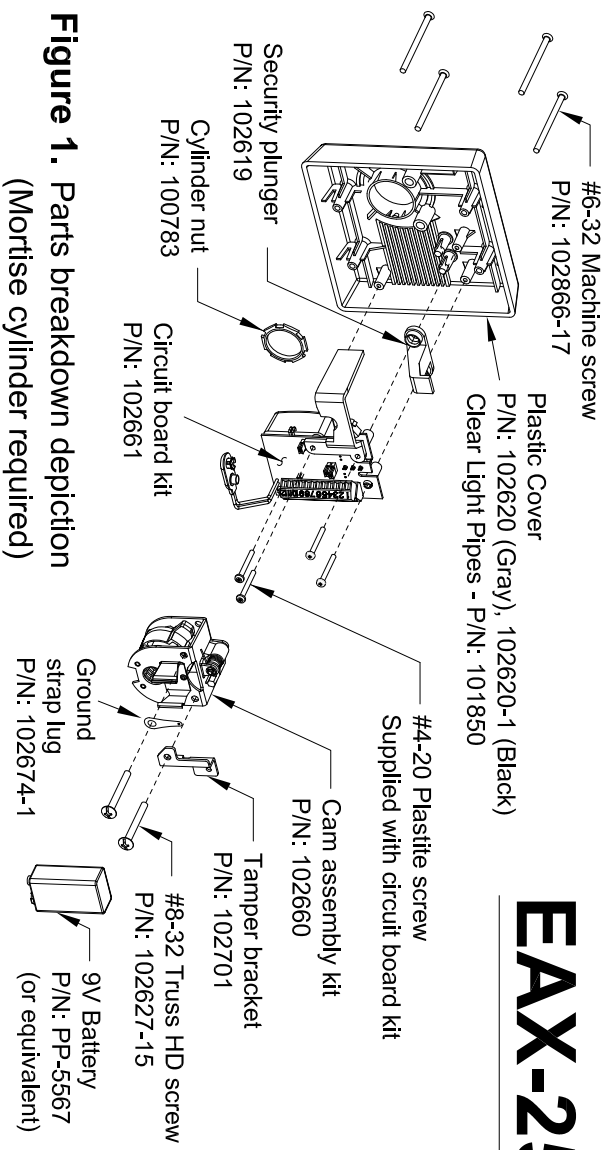

Figure 1. Parts breakdown depiction (Mortise cylinder required)

1. Supplied ground strap MUST be connected from back box.
2. Back box MUST be grounded per National Electrical Code requirements.
3. Ground strap MUST be as short as possible.
4. Units are shipped with ground strap installed.

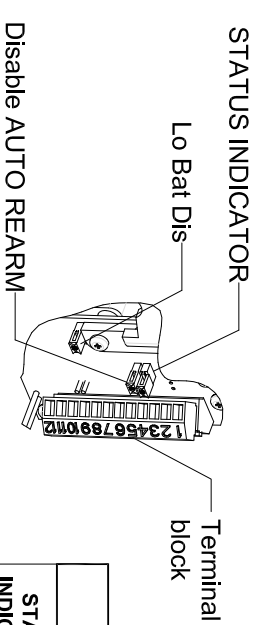

Figure 2. Selector switches

NOTE: Switch selections must be made before applying power or installing battery

Table 1	
STATUS INDICATOR	STATUS DESCRIPTION
Off (Default)	No indication that device is disarmed or armed.
On	ARMED- red LED blinks approximately every 15 seconds. DISARMED- green LED blinks approximately every 15 seconds.

Table 2	
Disable AUTO REARM	AUTO REARMING
Off	Alarm will automatically rearm 2 minutes after alarm has been activated, and door closed Custom settings can be programmed by DETEX.
On (Default)	Alarm will not automatically rearm after alarm has been activated.

Table 3 (AC power must be applied)	
Lo Bat Dis	Disable low battery warning
On	No indication of battery being low
Off (Default)	One red LED flash & one chirp about every 45 seconds

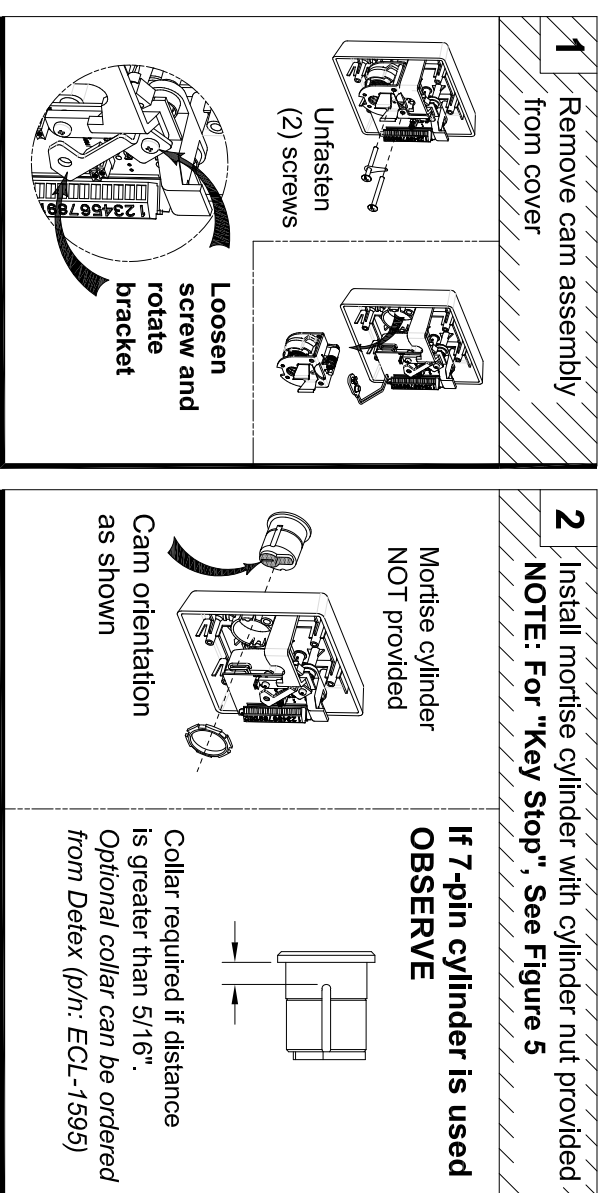

STEP 6-8: INSTALL DEVICE

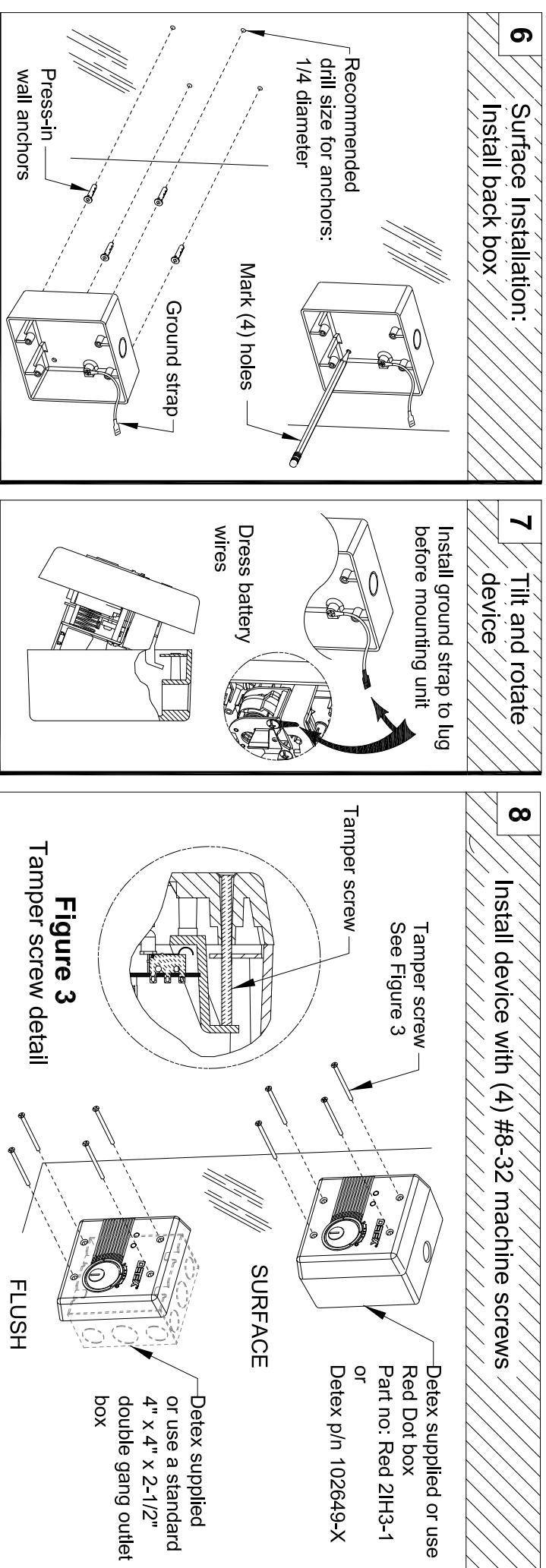
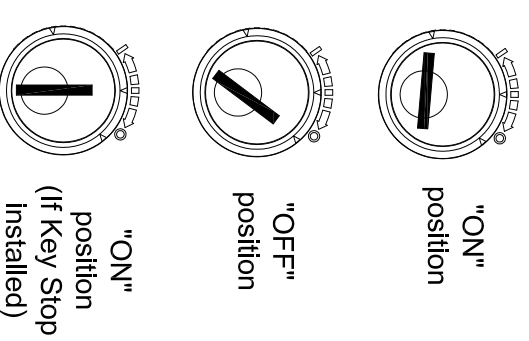

Figure 4
Key orientation



NOTE:
Key Stop will prevent key removal in "OFF" position

Table 4		
Terminal Block	Functions	Description
1	Power (AC or DC+)	12-24V
2	Power (AC or DC-)	
3	Remote Bypass (Open Contact)	Close to Activate
4	Remote Bypass (Common)	Close to Activate
5	Magnetic Door Switch (Closed Contact, Door Secure)	Open to Activate
6	Magnetic Door Switch (Common)	Open to Activate
7	Call Bell	Close to Activate
8	Call Bell	
9	Spare Ground (GND)	Alarm Relay Contacts
10	Remote Signal (Common)	
11	Remote Signal (Open)	Alarm Relay Contacts
12	Remote Signal (Closed)	