

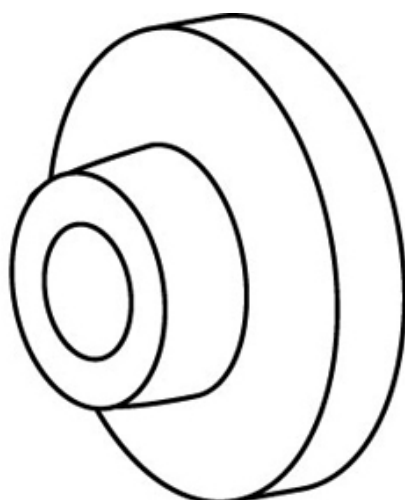

[Homepage](#) > [Products](#) > [Stops And Holders](#) > [Wall Bumper - Cast & Wrought](#)

Trimco Stops And Holders: Wall Bumper - Cast & Wrought



CV / WV

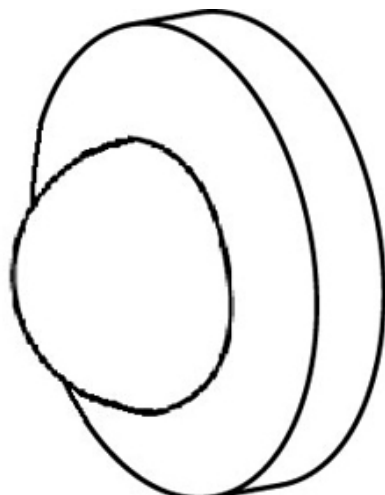

CX / WX

Part	Template
1270CV	18954
1270CX	18954
1270WV	18954
1270WX	18954

1270CV:
Cast with Concave rubber (1270CVCP, 1270CVTB,
1270CVMS)
BHMA: L02251

1270CX:
Cast with Convex rubber (1270CXCP, 1270CXTB,
1270CXMS)
BHMA: L02101

1270WV:
Wrought with Concave rubber (1270WVCP, 1270WVTB,
1270WVMS)
BHMA: L02251

1270WX:
Wrought with Convex rubber (1270WXCP, 1270WXTB,
1270WXMS)
BHMA: L02101

Packaged with all of the following fasteners:

- Wood Screw with Rawl Plug and Plastic Toggle
- Machine Screw and Metal Toggle Bolt
- Machine Screw and Anchor

Br, Bz, Pl, Al, SS



P.O. Box 23277 • [3528 Emery Street, Los Angeles, CA, 90023](#) • telephone: 323-262-4191 • fax: 323-264-7214 • toll-free fax: 800-637-TRIM (8746)
info@trimcobbw.com • quotes@trimcobbw.com • toll-free **quotes only** fax: 877-786-8387

© 2009 Triangle Brass Manufacturing Co., Inc.