

A6200-7B SERIES ROUND KNOB INSTALLATION



NOTES

1. TRIM CAN BE MOUNTED UP, DOWN, HORIZONTALLY OR VERTICALLY. **
2. USES STANDARD 161 DOOR PREP.
3. VISION LITE MUST BE AT LEAST 6" FROM LATCH PREP.

ITEM	QTY	PART DESCRIPTION
1	1	COVER
2	4	8-32 X 3/8" F.H.M.S.
3	4	10-32 X 1-1/2" PH. PAN HD. M.S.
4	1	HANDLE ASSEMBLY
5	2	#8 X 3/4" PH. FL. HD. W.S.
6	1	LATCH
7	1	7B ASYLUM ASSEMBLY PLATE
8	.	.
9	REF	SPRING
10	REF	PIN & COTTER PIN

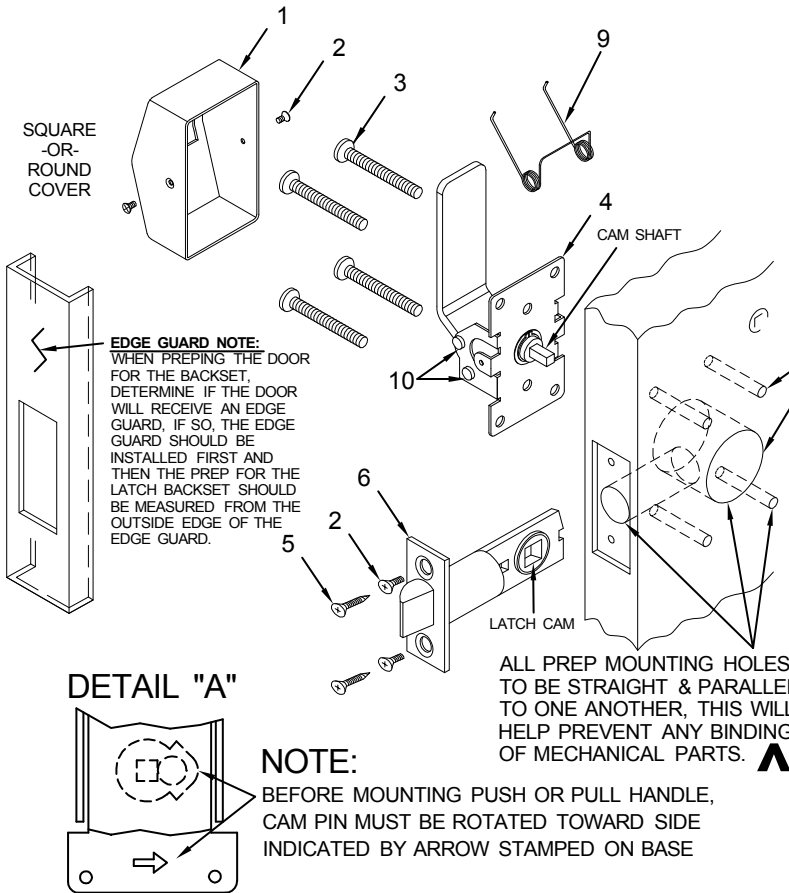

VERIFY CORRECT BACKSET AND HORIZONTAL OR VERTICAL MOUNTING BEFORE DRILLING. THEN USE BACKSET TEMPLATE THAT IS SUPPLIED.
▲ = (4) THRU HOLES MUST BE 3/8" DIA.

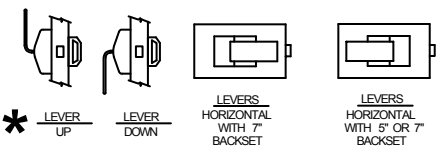
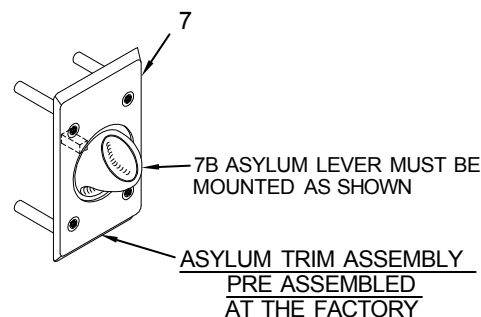

INSTALLATION INSTRUCTIONS:

1. PREP DOOR ACCORDING TO LATCH BACKSET AND DETERMINE IF TRIM IS TO BE MOUNTED HORIZONTAL OR VERTICAL MOUNTING USING BACKSET TEMPLATE. ▲
2. INSTALL LATCH USING EITHER WOOD (item 5) OR MACHINE SCREWS (item 2) DEPENDING ON DOOR TYPE.
3. ASSEMBLE TRIM:
 - A) SELECT THE HANDLE FIRST. WITH HANDLE IN HAND, ROTATE THE CAM ASSEMBLY UNTIL THE CAM PIN STOPS ON THE APPROPRIATE SIDE INDICATED BY THE ARROW (SEE DETAIL "A").
 - B) PLACE HANDLE ON APPROPRIATE SIDE OF THE DOOR AND SLIDE CAM SHAFT THROUGH THE LATCH CAM, THEN PLACE THE ASYLUM TRIM ON THE OTHER SIDE OF THE DOOR ENGAGING THE ASYLUM CAM ONTO THE HANDLE CAM SHAFT. MOUNT TRIM WITH (4) 10-32x1-1/2" MACHINE SCREWS (item 3). TEST BOTH TRIM HANDLES FOR FREE MOVEMENT OF THE LATCH BOLT BEFORE TIGHTENING ALL SCREWS. IF LATCH BOLT DOES NOT EXTEND OR RETRACT FREELY BECAUSE OF ANY TYPE OF BINDING. LOOSEN MOUNTING SCREWS TO ADJUST ALIGNMENT OF TRIM AND RETIGHTEN SCREWS ONE AT A TIME WHILE CHECKING LATCH BOLT MOVEMENT FROM BOTH SIDES OF THE DOOR.
 - C) TEST FOR PROPER OPERATION AND CHECK THAT THE MOUNTING HARDWARE (item 3) & (item 7) **IS TIGHT** BEFORE PROCEEDING WITH THE NEXT STEP.
 - D) PLACE COVER (item 1) OVER HANDLE TRIM ASSEMBLY AND SECURE WITH (2) FLAT HEAD SCREWS (item 2).

PATENT No. 6,196,599



® www.abhmfg.com
 E-mail: abhinfo@abhmfg.com
 Architectural Builders Hardware Mfg., Inc.
 1222 Ardmore Ave., Itasca, IL 60143
 630.875.9900; FAX 800.9FAXABH (932.9224)

A6200-7B INSTALLATION-1-03.DWG

A6200-7B

REVISED 09-16-14

© 2014 ABH Mfg., Inc.
 printed in USA