

Hospital Push/Pull Latches



Innovation, Quality,
Customer Service...

6700 Series

Trim Only for use with Other Manufacturers' Mortise Lock Body

Standard Features

- ABH custom manufactures the hospital push/pull trim to work with other manufacturers' mortise lock bodies.
- Great for retrofit applications where the owner wants to keep existing lock bodies and keep keying system in-tact and keep costs low.
- Models and manufacturers are as follows:
 - 6710 - Trim for Best*, Falcon*, Marks*, Dorma* mortise lock body
 - 6720 - Trim for Schlage* mortise lock body
 - 6730 - Trim for Yale* mortise lock body
 - 6740 - Trim for Corbin Russwin* mortise lock body
 - 6750 - Trim for Sargent* mortise lock body
 - 6760 - Trim for PDQ* mortise lock body
 - 6770 - Trim for Arrow* mortise lock body
- No mortise lock body or strike supplied
- Must complete special order form found online www.abhmfg.com or by sending in a sample mortise lock body being used prior to manufacturing
- 1-3/4" standard door thickness minimum (specify if other than 1-3/4")
- Meets ADA requirements
- All mounting hardware goes through existing mortise lock body prep - no additional prep required
- One continuous spring provides a smoother operation and an extended life for the unit
- Push/pull trim is non-handed
- Can be mounted vertical or horizontal (with handles pointing toward hinge edge of door)
 - For mortise lock functions where thumb turn will be used, either mount the trim horizontal or select "J" option (Junior Covers) to achieve required clearance
- Handles can be mounted up or down by simply rotating trim 180°
- UL Listed in U.S.A and Canada for use on door fire rated 3 hour or less, up to 4'0" x 8'0"

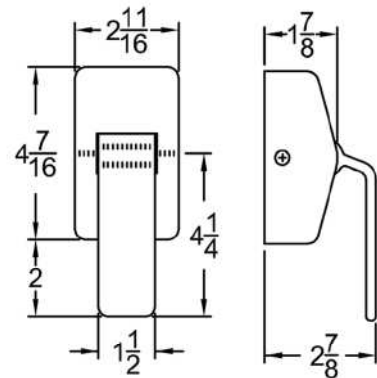

How to Order:

Example: 6710 US32D - AM

Model: _____

- 6710 • 6720 • 6730
- 6740 • 6750 • 6770

Finish: _____

- US32D • US32 • US10B • US3
- US26D • US26 • US10 • US4

Options, if Needed: _____

- H • AM • PL • PS • EX • X • J • RC • SEC • THICK • AB • PSA • PLA • P
- (See pages C-3 to C-5 for details)

*Brand names are trademarks or registered trademarks of their respective companies.



Architectural Builders Hardware Manufacturing, Inc.
1222 Ardmore Avenue, Itasca, IL 60143
Tel: 630-875-9900 • Fax: 630-875-9918 / 800-932-9224
Web: www.abhmfg.com • Email: abhinfo@abhmfg.com

DISTRIBUTED BY

